



HERITAGE

- REDROW -

THE OXFORD LIFESTYLE

THREE BEDROOM DETACHED
ECO ELECTRIC HOME



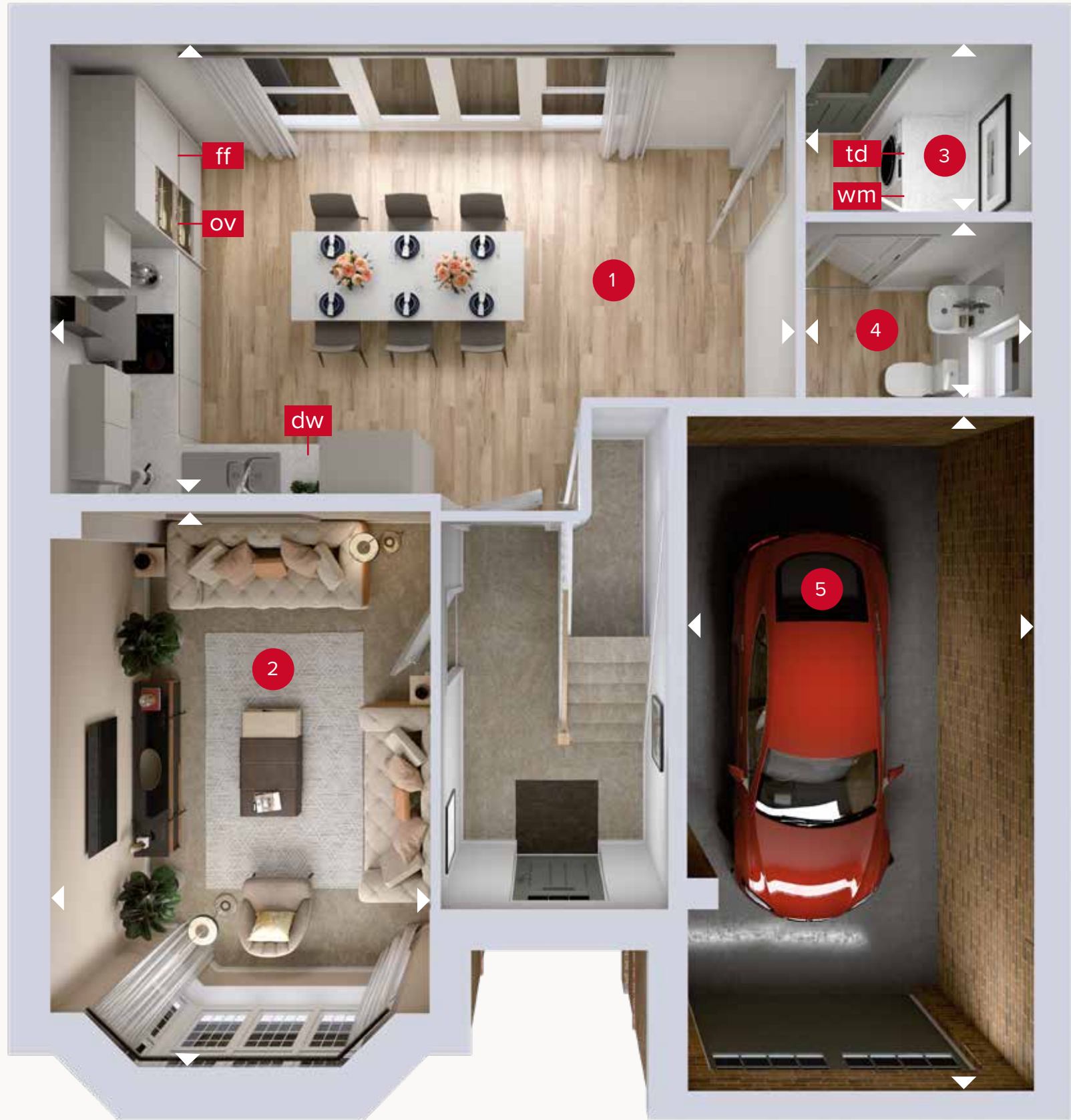

GROUND FLOOR



FIRST FLOOR

THE OXFORD LIFESTYLE ECO ELECTRIC

GROUND FLOOR

1	Kitchen/Dining	20'10" x 12'9"	6.36 x 3.88 m
2	Lounge	15'11" x 10'7"	4.85 x 3.23 m
3	Utility	6'5" x 4'7"	1.96 x 1.43 m
4	Cloaks	6'4" x 4'10"	1.93 x 1.48 m
5	Garage	19'4" x 9'8"	5.89 x 2.94 m

FIRST FLOOR

6	Bedroom 1	16'0" x 10'7"	4.87 x 3.23 m
7	Dressing Room	7'5" x 6'8"	2.30x 2.03 m
8	En-suite 1	10'7" x 5'11"	3.23 x 1.80 m
9	Bedroom 2	12'7" x 10'8"	3.84 x 3.26 m
10	En-suite 2	7'9" x 5'7"	2.36 x 1.72 m
11	Bedroom 3	11'9" x 9'11"	3.57 x 3.02 m
12	En-suite 3	8'3" x 6'6"	2.51 x 1.98 m