



HERITAGE

- REDROW -

THE CHESTER

FOUR BEDROOM DETACHED HOME





GROUND FLOOR

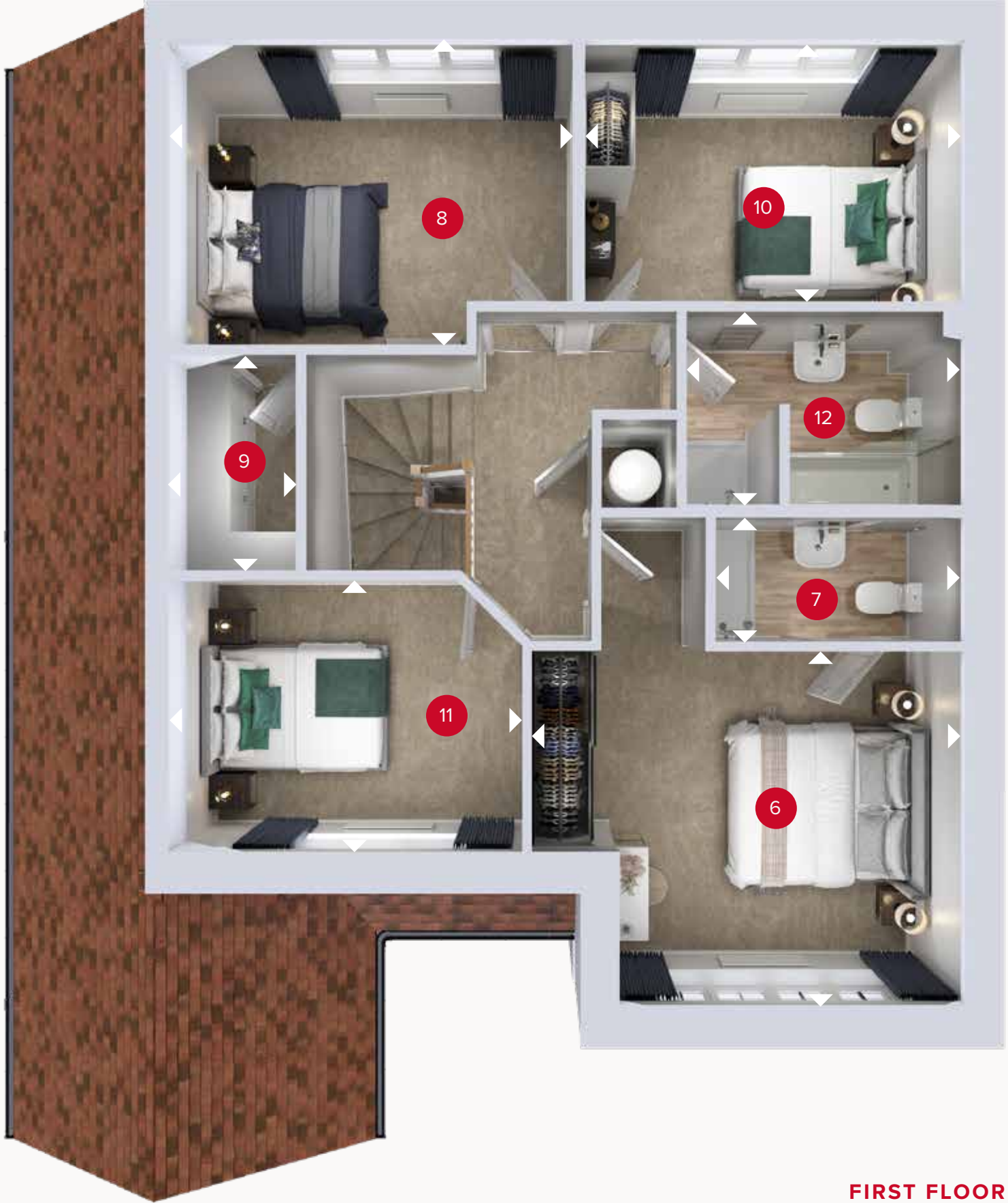

FIRST FLOOR

THE CHESTER

GROUND FLOOR

1	Kitchen/Dining Family	30'6" x 12'6"	9.31 x 3.83 m
2	Lounge	17'5" x 10'11"	5.32 x 3.34 m
3	Utility	9'5" x 5'0"	2.88 x 1.54 m
4	Cloaks	5'8" x 3'7"	1.74 x 1.09 m
5	Garage	19'0" x 11'1"	5.80 x 3.38 m

FIRST FLOOR

6	Bedroom 1	15'5" x 13'7"	4.70 x 4.16 m
7	En-suite	7'10" x 3'10"	2.41 x 1.19 m
8	Bedroom 2	12'9" x 9'8"	3.91 x 2.96 m
9	Dressing Room	6'10" x 4'2"	2.07 x 1.26 m
10	Bedroom 3	12'0" x 8'4"	3.66 x 2.54 m
11	Bedroom 4	11'3" x 8'7"	3.43 x 2.63 m
12	Bathroom	8'9" x 6'1"	2.69 x 1.86 m



25.09.2023

Customers should note this illustration is an example of the Chester house type. All dimensions indicated are approximate and the furniture layout is for illustrative purposes only. Homes may be 'handed' (mirror image) versions of the illustrations, and may be detached, semi-detached or terraced. Materials used may differ from plot to plot including render and roof tile colours. Detailed plans and specifications are available for inspection for each plot at our Customer Experience Suite or Sales Centre during working hours and customers must check their individual specifications prior to making a reservation. Please note that the specification show in this plan may include optional upgrades from standard specification. Please speak with your Sales Consultant or visit MyRedrow for more information. 00924-06 EG_CHTR_DM.2

➤ Denotes where dimensions are taken from. All wardrobes are subject to site specification. Please see Sales Consultant for further details.

ov - oven
ff - fridge freezer
dw - dishwasher space

wm - washing machine space
td - tumble dryer space

