



HERITAGE

- REDROW -

THE HARROGATE

FOUR BEDROOM DETACHED HOME

 **REDROW**

THE HARROGATE

GROUND FLOOR

1	Lounge	15'4" x 12'0"	4.68 x 3.65 m
2	Kitchen	12'5" x 10'1"	3.79 x 3.09 m
3	Dining	12'4" x 10'3"	3.78 x 3.13 m
4	Family	13'8" x 9'11"	4.17 x 3.04 m
5	Cloaks	6'4" x 4'9"	1.95 x 1.45 m
6	Utility	6'4" x 5'1"	1.95 x 1.57 m

FIRST FLOOR

7	Bedroom 1	12'2" x 10'10"	3.72 x 3.05 m
8	Dressing	6'9" x 6'5"	2.08 x 1.96 m
9	En-suite	8'1" x 5'6"	2.47 x 1.69 m
10	Bedroom 2	13'8" x 9'8"	4.18 x 2.97 m
11	Bedroom 3	12'1" x 9'8"	3.69 x 2.97 m
12	Bedroom 4	11'0" x 9'11"	3.40 x 3.36 m
13	Bathroom	7'10" x 6'2"	2.41 x 1.90 m

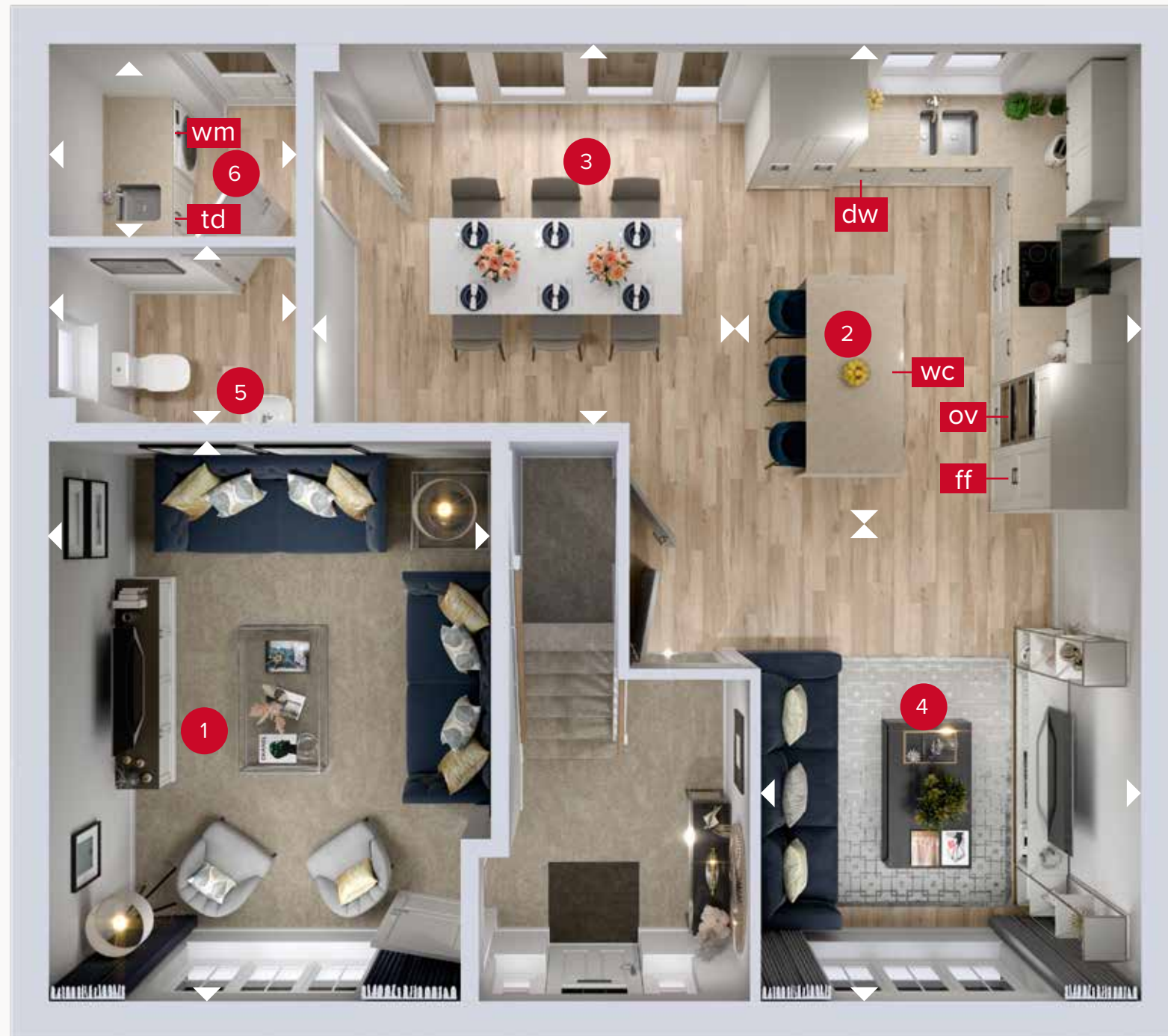

GROUND FLOOR

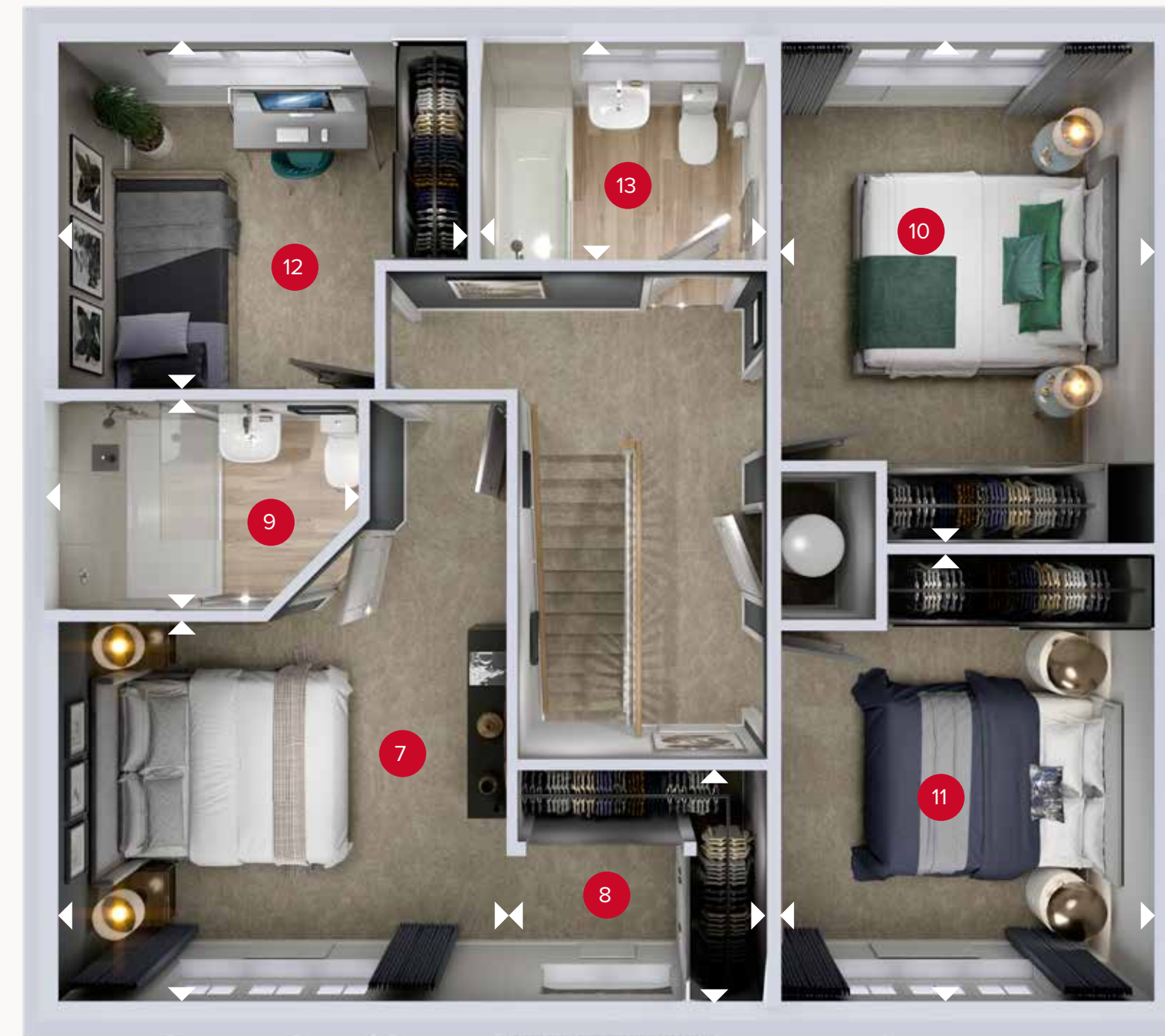

FIRST FLOOR

▷ Denotes where dimensions are taken from. All wardrobes are subject to site specification. Please see Sales Consultant for further details.

ov - oven
ff - fridge freezer
dw - dishwasher if selected
wm - washing machine if selected
td - tumble dryer if selected
wc - wine cooler if selected