



HERITAGE

- REDROW -

THE HENLEY

FOUR BEDROOM DETACHED HOME

 **REDROW**

THE HENLEY

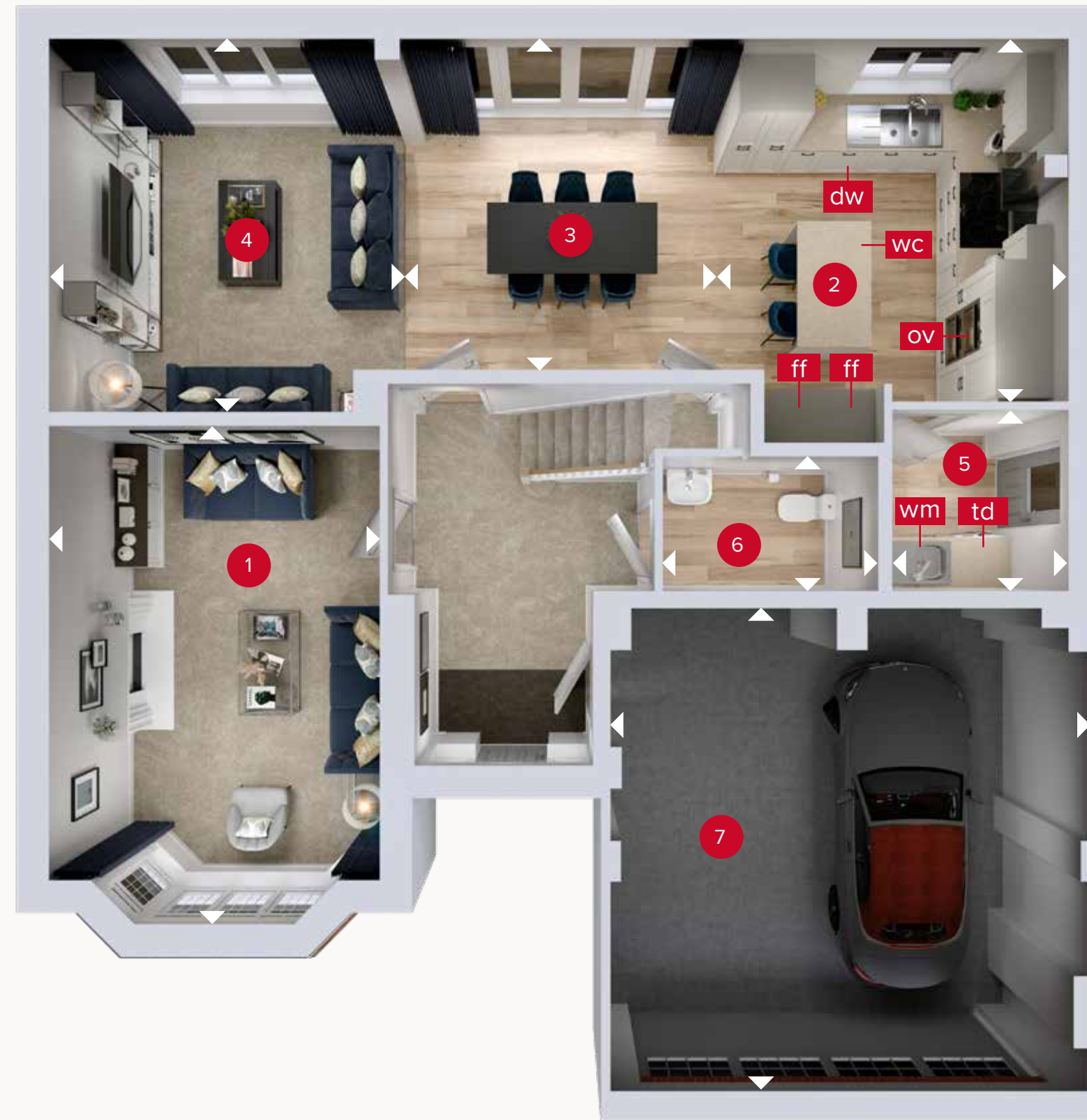

GROUND FLOOR

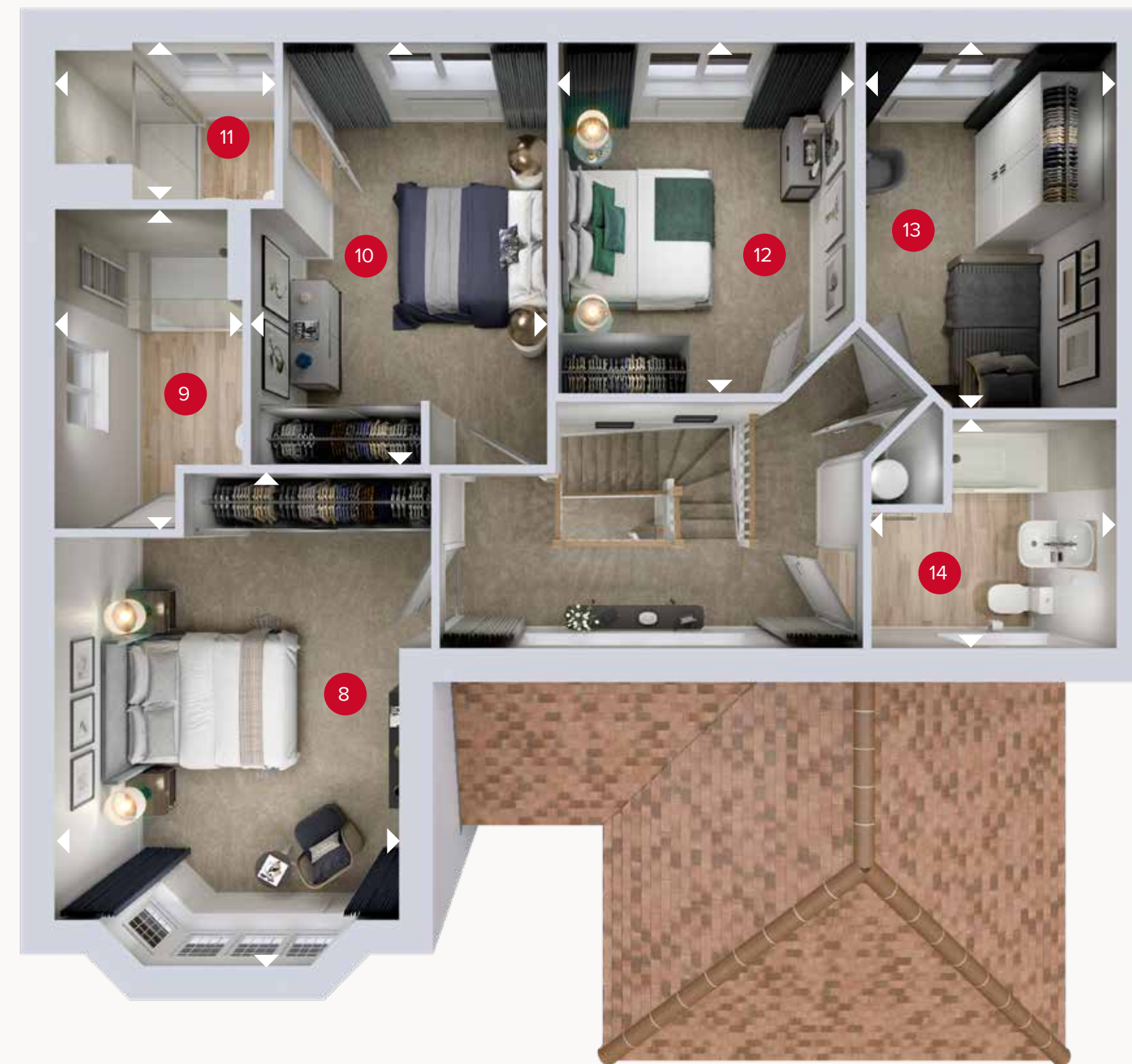

FIRST FLOOR

GROUND FLOOR

1	Lounge	17'8" x 11'8"	5.37 x 3.57 m
2	Kitchen	12'9" x 11'5"	3.91 x 3.57 m
3	Dining	13'1" x 11'8"	3.99 x 3.57 m
4	Family	13'2" x 11'6"	4.03 x 3.51 m
5	Utility	6'5" x 6'2"	1.96 x 1.90 m
6	Cloaks	7'7" x 4'9"	2.32 x 1.45 m
7	Garage	17'7" x 17'0"	5.37 x 5.19 m

FIRST FLOOR

8	Bedroom 1	16'8" x 11'8"	5.09 x 3.57 m
9	En-suite 1	10'9" x 6'5"	3.28 x 1.94 m
10	Bedroom 2	14'4" x 10'0"	4.37 x 3.07 m
11	En-suite 2	7'5" x 5'4"	2.27 x 1.63 m
12	Bedroom 3	11'10" x 10'0"	3.63 x 3.07 m
13	Bedroom 4	12'5" x 8'6"	3.78 x 2.59 m
14	Bathroom	8'4" x 7'9"	2.54 x 2.37 m