



TAILORED

- REDROW -

THE RUTLAND

FOUR BEDROOM HOME



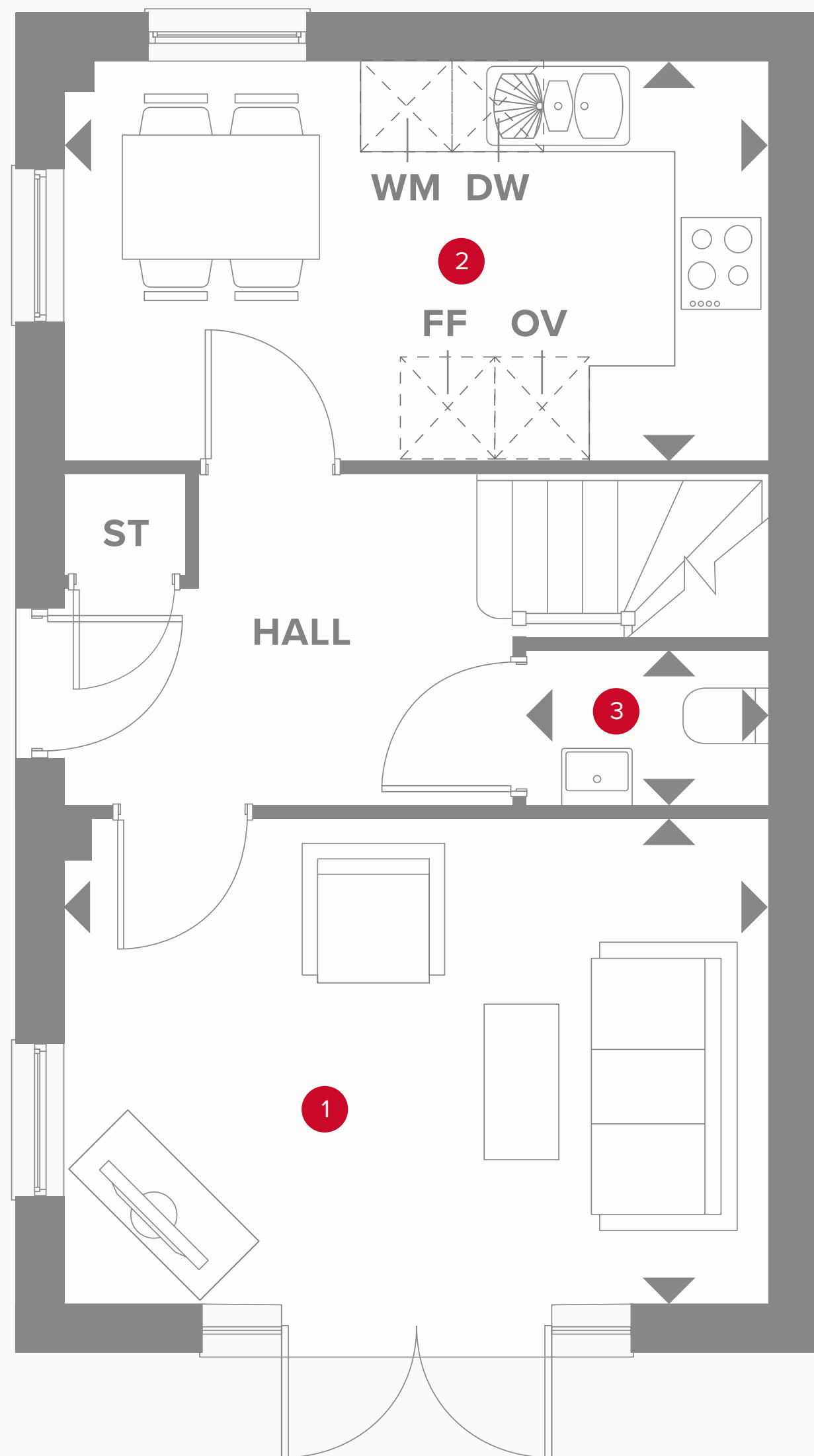



THE RUTLAND GROUND FLOOR

1	Family	15'3" x 10'4"	4.65 x 3.19 m
2	Kitchen/Dining	15'3" x 8'6"	4.65 x 2.62 m
3	Cloaks	5'3" x 3'4"	1.60 x 1.05 m



KEY

-  Hob
- OV** Oven
- FF** Fridge/freezer
-  Dimensions start

- ST** Storage cupboard
- WM** Washing machine space
- DW** Dish washer space

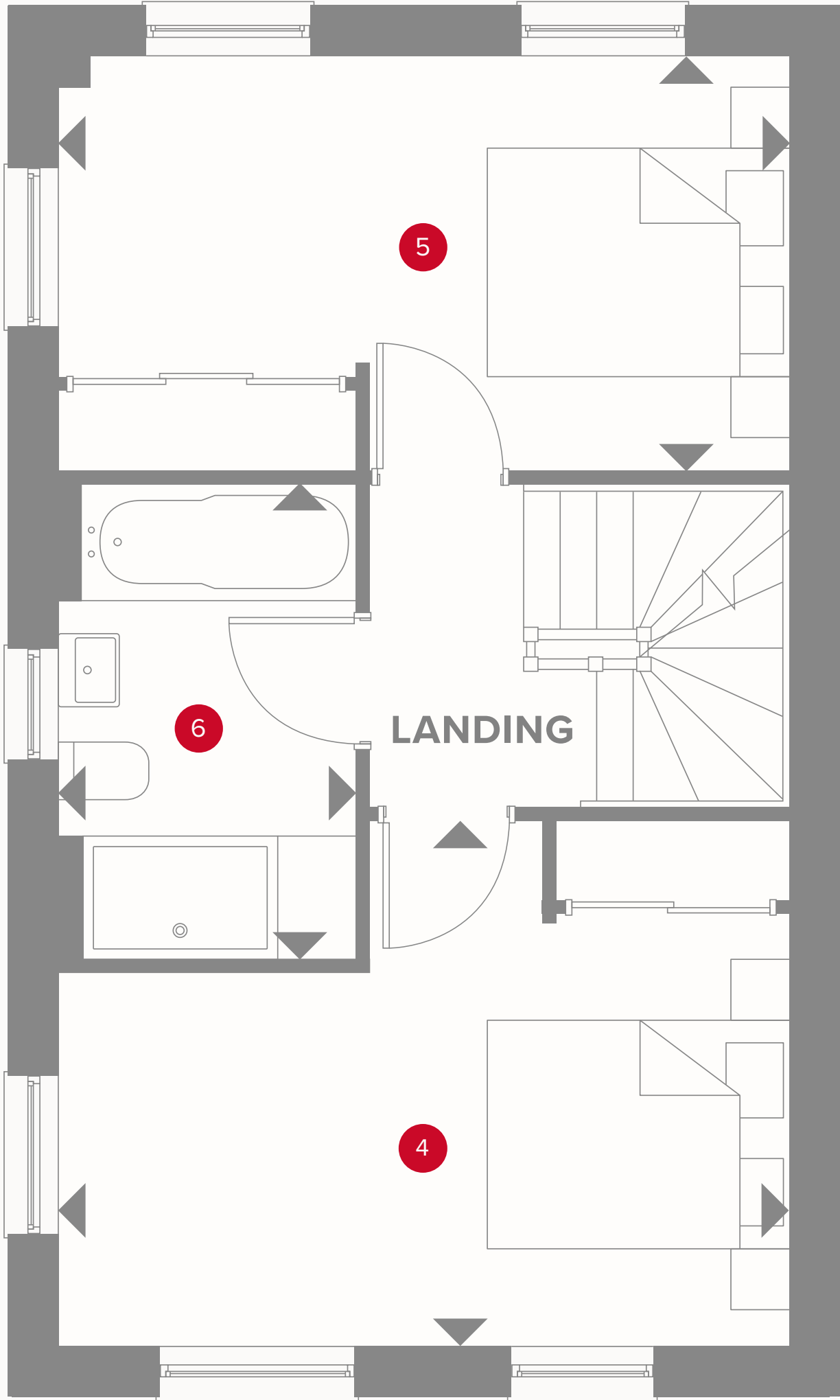

THE RUTLAND FIRST FLOOR

4	Bedroom 3	15'3" x 10'6"	4.65 x 3.24 m
5	Bedroom 4	15'3" x 8'7"	4.65 x 2.66 m
6	Bathroom	6'2" x 9'7"	1.90 x 2.96 m



KEY

◀ Dimensions start

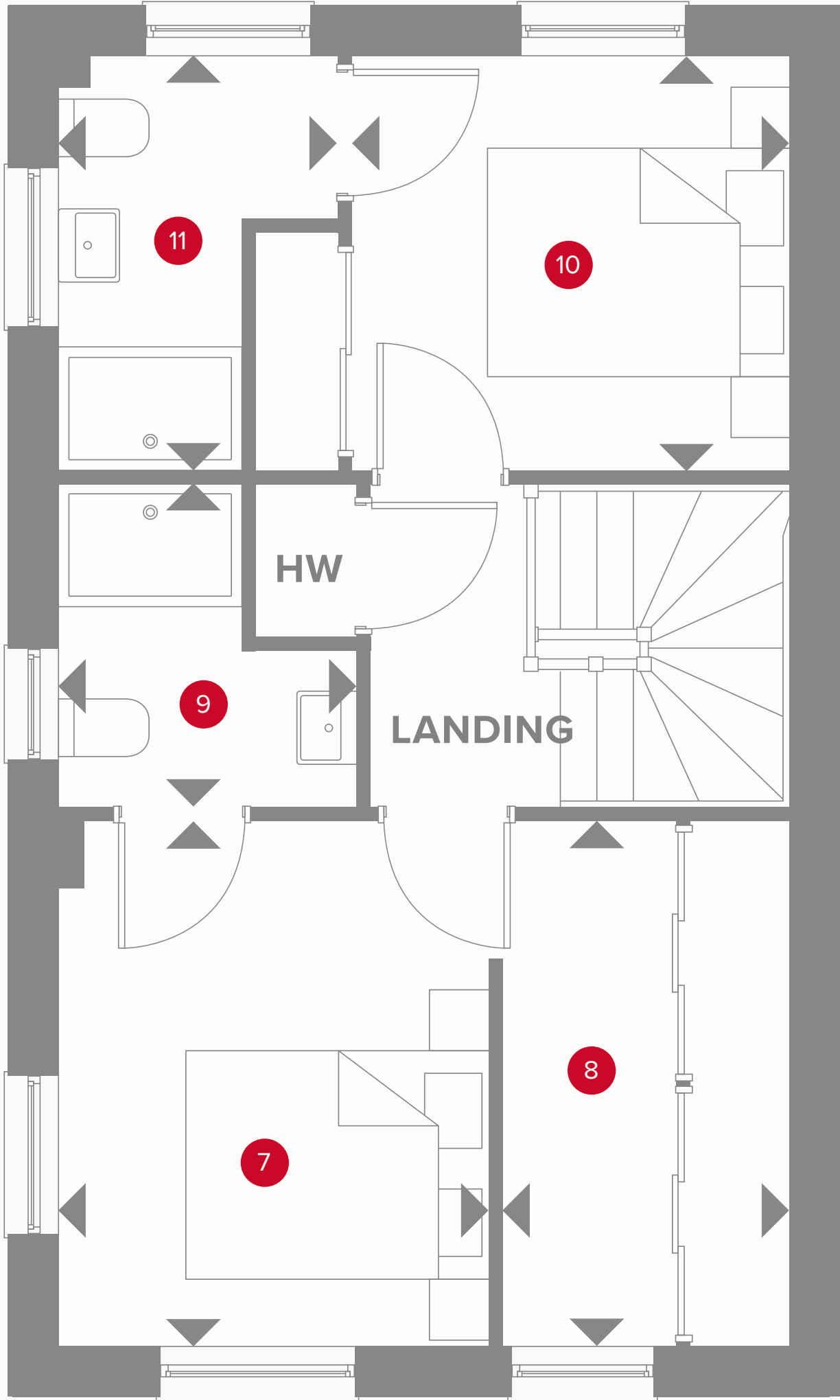

THE RUTLAND SECOND FLOOR

7	Bedroom 1	9'1" x 11'	2.76 x 3.37 m
8	Dressing Area	5'9" x 10'6"	1.80 x 3.24 m
9	En-suite	6'3" x 6'6"	1.91 x 2.01 m
10	Bedroom 2	11'1" x 8'7"	3.37 x 2.66 m
11	En-suite	5'9" x 8'7"	1.80 x 2.66 m



KEY

◀ Dimensions start

HW Hot water storage



Customers should note this illustration is an example of the Harrogate house type. All dimensions indicated are approximate and the furniture layout is for illustrative purposes only. Homes may be 'handed' (mirror image) versions of the illustrations, and may be detached, semi-detached or terraced. Materials used may differ from plot to plot including render and roof tile colours. Detailed plans and specifications are available for inspection for each plot at our Sales Centre during working hours and customers must check their individual specifications prior to making a reservation.