



HERITAGE

- REDROW -

THE RICHMOND PREMIUM

FOUR BEDROOM HOME





HERITAGE

- REDROW -

THE RICHMOND PREMIUM

FOUR BEDROOM HOME

 **REDROW**

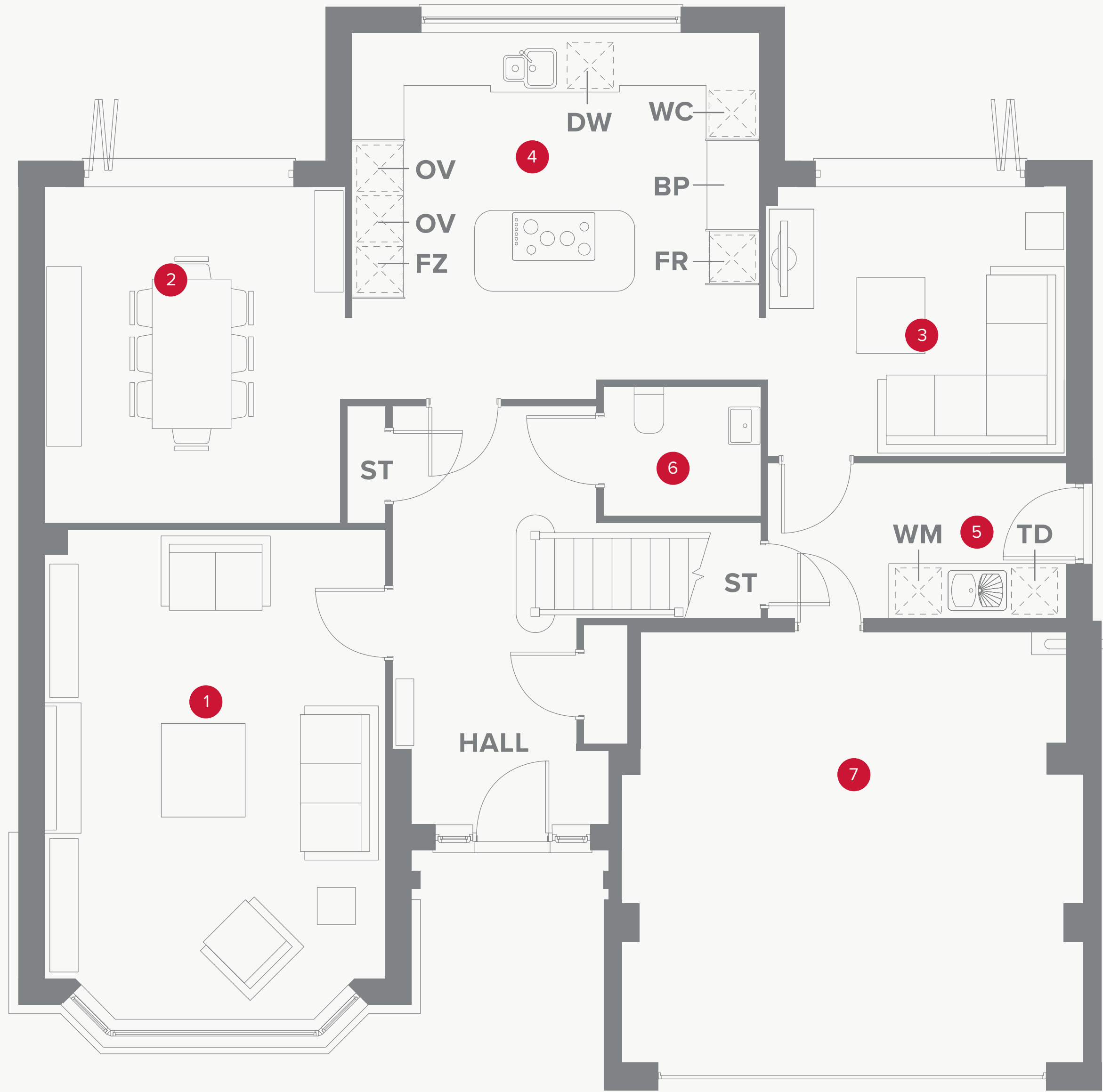



THE RICHMOND PREMIUM GROUND FLOOR

1	Lounge	18'7" x 13'0"	5.67 x 3.97 m
2	Family	11'6" x 10'1"	3.51 x 3.08 m
3	Dining	12'10" x 11'6"	3.91 x 3.51 m
4	Kitchen	15'7" x 14'0"	4.76 x 4.27 m
5	Utility	11'4" x 6'2"	3.46 x 1.88 m
6	Cloaks	5'10" x 4'9"	1.77 x 1.45 m
7	Garage	17'9" x 17'0"	5.41 x 5.21 m



KEY

-  Hob
- OV** Oven
- FR** Fridge
- FZ** Freezer
- TD** Tumble dryer space
- BP** Butler Pantry

-  Dimensions start
- ST** Storage cupboard
- WM** Washing machine space
- DW** Dish washer space
- WC** Wine cooler

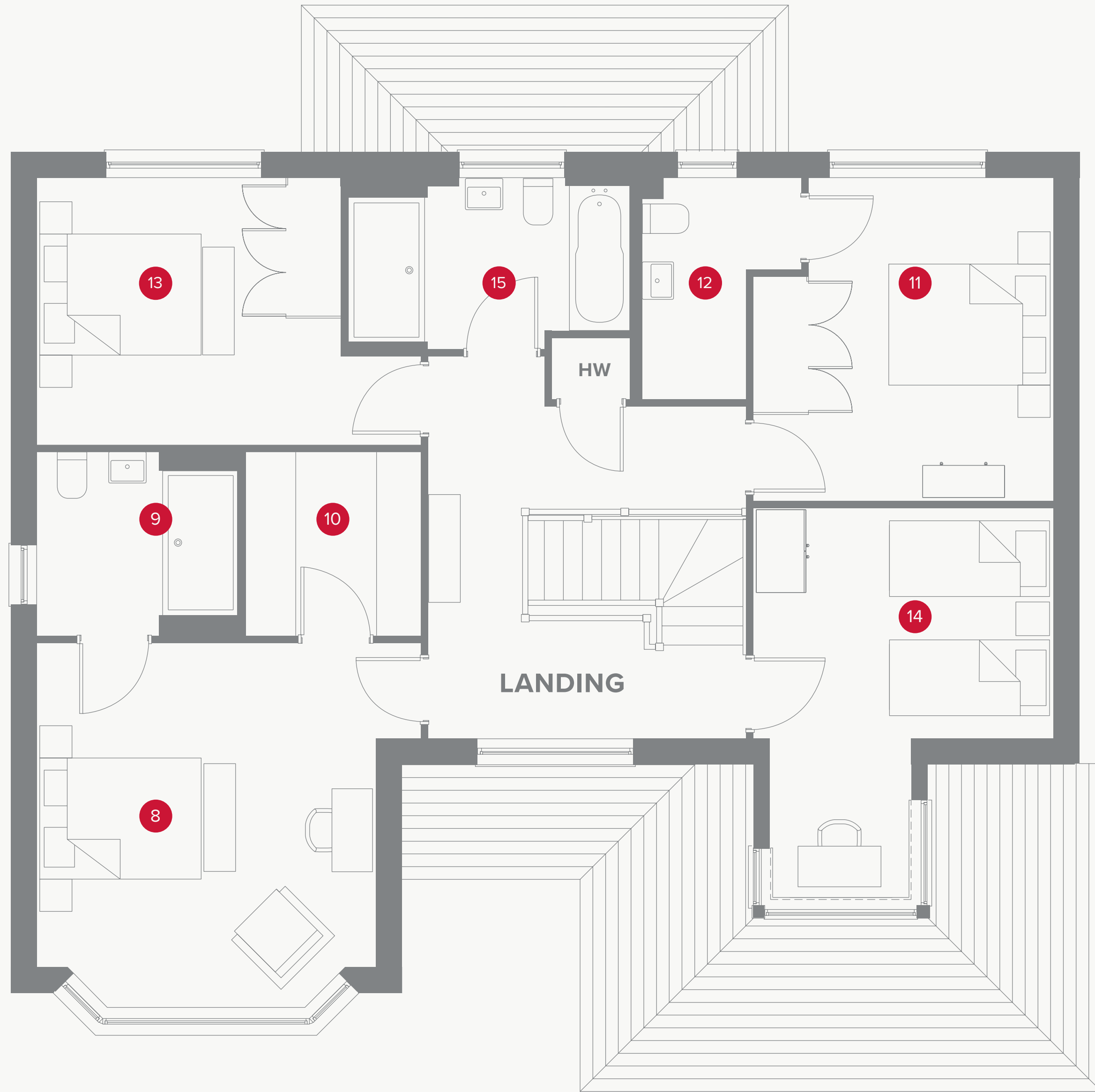

THE RICHMOND PREMIUM FIRST FLOOR

8	Bedroom 1	14'0" x 13'0"	4.27 x 3.97 m
9	En-suite 1	7'8" x 7'1"	2.33 x 2.15 m
10	Wardrobe	7'1" x 6'10"	2.17 x 2.08 m
11	Bedroom 2	12'2" x 11'7"	3.70 x 3.52 m
12	En-suite 2	8'6" x 6'1"	2.58 x 1.86 m
13	Bedroom 3	11'9" x 10'1"	3.57 x 3.08 m
14	Bedroom 4	15'6" x 11'7"	4.72 x 3.52 m
15	Bathroom	10'8" x 6'6"	3.26 x 1.97 m



KEY

- ◀ Dimensions start
- HW Hot water storage

**CONSUMER
CODE FOR
HOME BUILDERS**
www.consumercode.co.uk

Customers should note this illustration is an example of the Richmond house type. All dimensions indicated are approximate and the furniture layout is for illustrative purposes only. Homes may be 'handed' (mirror image) versions of the illustrations, and may be detached, semi-detached or terraced. Materials used may differ from plot to plot including render and roof tile colours. Detailed plans and specifications are available for inspection for each plot at our Sales Centre during working hours and customers must check their individual specifications prior to making a reservation.