



INSPIRED

- REDROW -

THE ARLEY

FIVE BEDROOM HOME



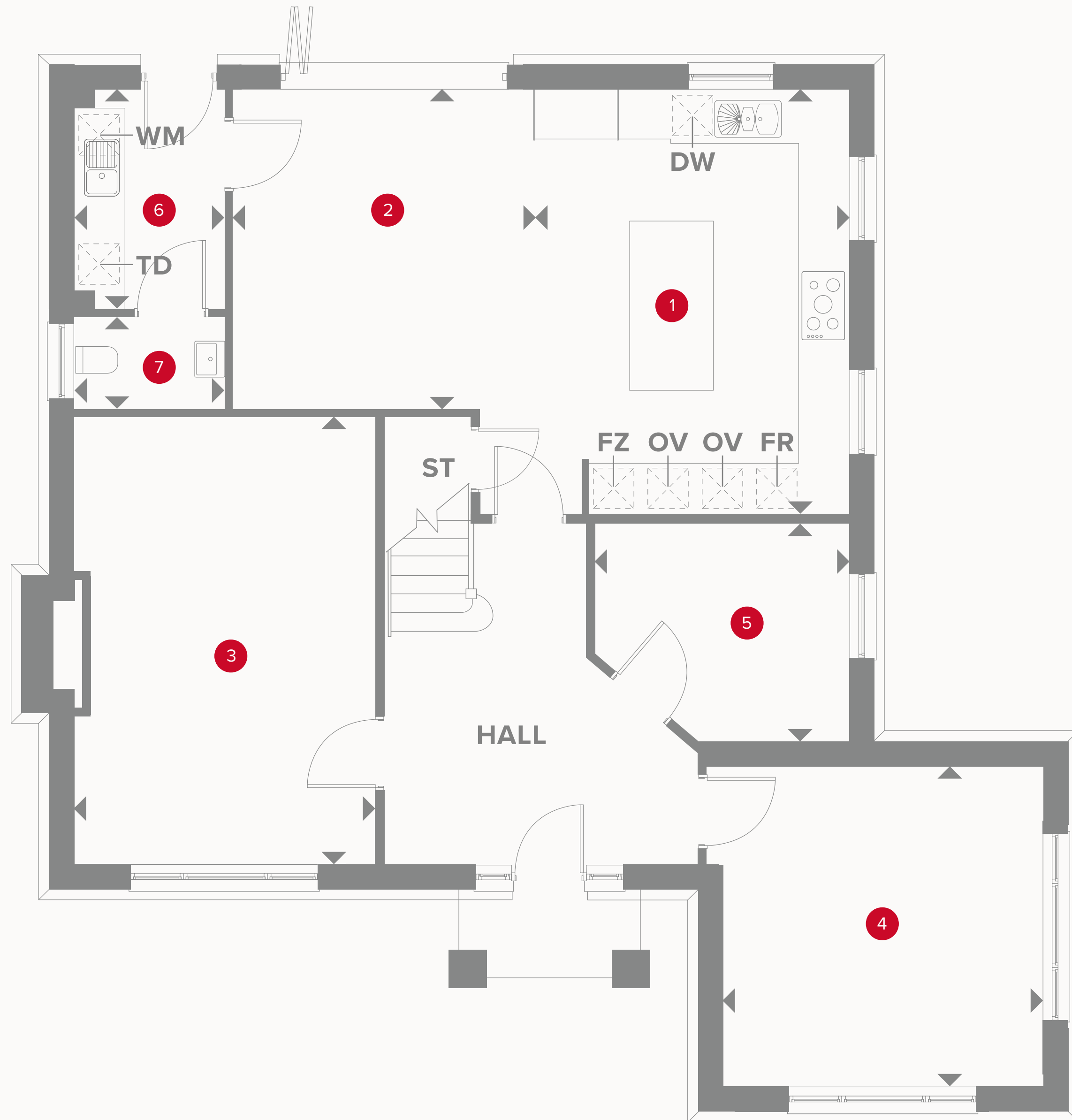

THE ARLEY GROUND FLOOR

1	Kitchen	16'8" x 12'5"	5.11x 3.81 m
2	Family	12'6" x 11'9"	3.83 x 3.61 m
3	Lounge	17'7" x 11'9"	5.38 x 3.62 m
4	Dining	12'7" x 12'7"	3.85 x 3.85 m
5	Office	10'0" x 8'4"	3.04 x 2.59 m
6	Utility	8'0" x 5'9"	2.43 x 1.78 m
7	Cloaks	5'9" x 3'6"	1.78 x 1.09 m



KEY

Hob
 Oven
 Fridge
 Freezer

Tumble dryer space
 Washing machine space
 Dish washer space

Dimensions start
 Storage cupboard

THE ARLEY FIRST FLOOR

8	Bedroom 1	13'2" x 11'6"	4.03 x 3.53 m
9	En-suite 1	11'0" x 10'8"	3.34 x 3.27 m
10	Dressing	12'0" x 8'0"	3.68 x 2.46 m
11	Bedroom 2	12'7" x 12'7"	3.85 x 3.85 m
12	En-suite 2	9'9" x 5'6"	3.00 x 1.70 m
13	Bedroom 3	11'0" x 10'7"	3.38 x 3.25 m
14	Bedroom 4	14'8" x 11'0"	4.49 x 3.36 m
15	Bathroom	7'7" x 7'1"	2.32 x 2.18 m



KEY

- HW** Hot water storage
- LH** Loft Hatch
- ST** Storage cupboard
- ◀ Dimensions start



THE ARLEY SECOND FLOOR

16	Bedroom 5	15'8" x 9'6"	4.79 x 2.90 m
17	Shower Room	10'1" x 5'7"	3.10 x 1.71 m
18	Attic Store	12'7" x 12'7"	3.85 x 3.85 m



KEY

- ◀ Dimensions start
- LH Loft hatch
- ST Storage Cupboard



Customers should note this illustration is an example of the Tatton house type. All dimensions indicated are approximate and the furniture layout is for illustrative purposes only. Homes may be 'handed' (mirror image) versions of the illustrations, and may be detached, semi-detached or terraced. Materials used may differ from plot to plot including render and roof tile colours. Detailed plans and specifications are available for inspection for each plot at our Sales Centre during working hours and customers must check their individual specifications prior to making a reservation.

