



INSPIRED

- REDROW -

THE CRANFORD

FIVE BEDROOM HOME



THE CRANFORD GROUND FLOOR

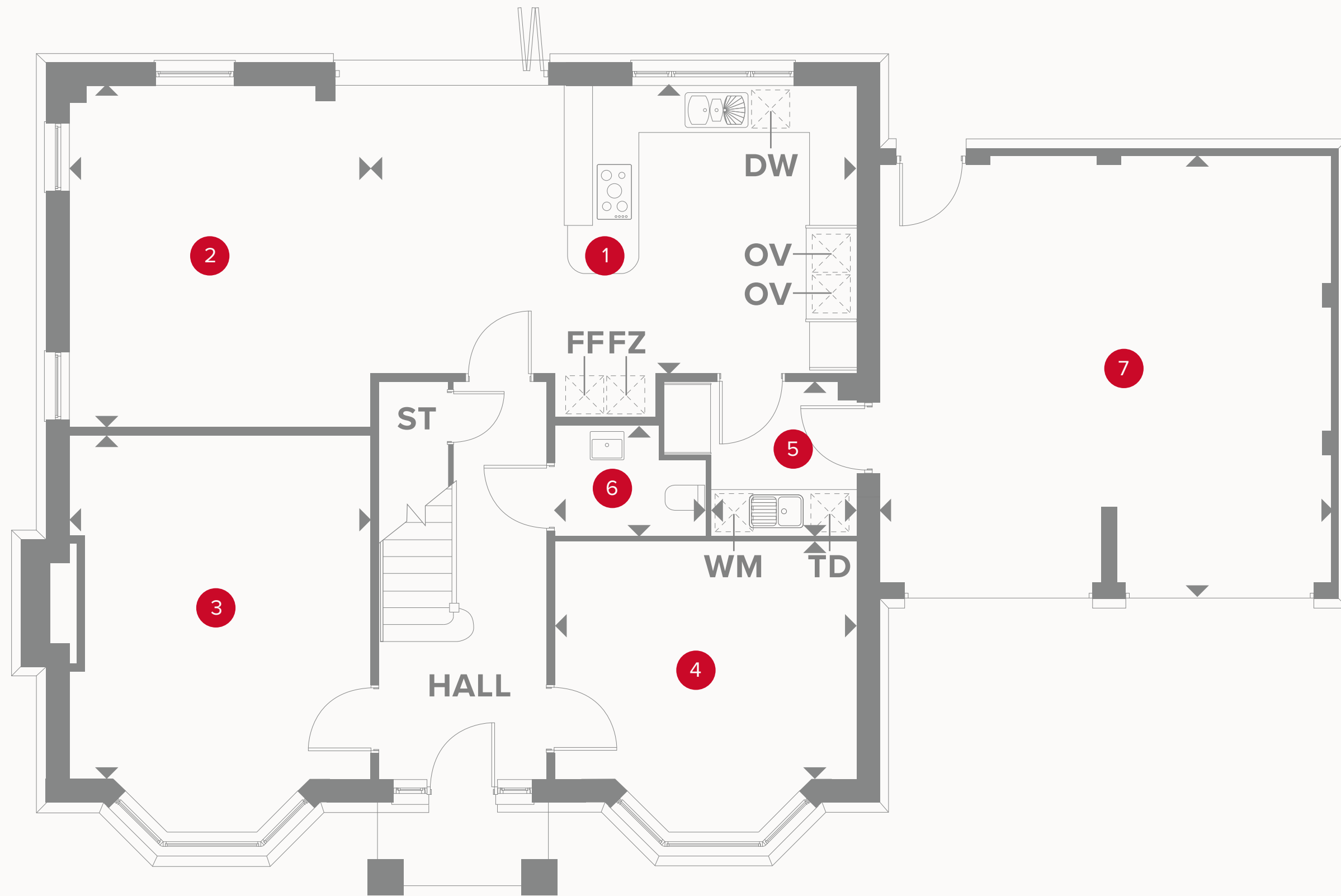

1	Kitchen/Breakfast	21'0" x 12'3"	6.43 x 3.76 m
2	Family	14'7" x 13'0"	4.48 x 3.95 m
3	Lounge	14'8" x 13'0"	4.51 x 3.95 m
4	Snug/Dining	13'0" x 10'2"	3.95 x 3.13 m
5	Utility	6'6" x 6'2"	2.00 x 1.90 m
6	Cloaks	6'4" x 4'9"	1.96 x 1.39 m
7	Garage	19'6" x 19'1"	5.97 x 5.83 m



KEY

	Hob		Dimensions start
OV	Oven	ST	Storage cupboard
FF	Fridge/freezer	WM	Washing machine space
TD	Tumble dryer space	DW	Dish washer space

THE CRANFORD FIRST FLOOR

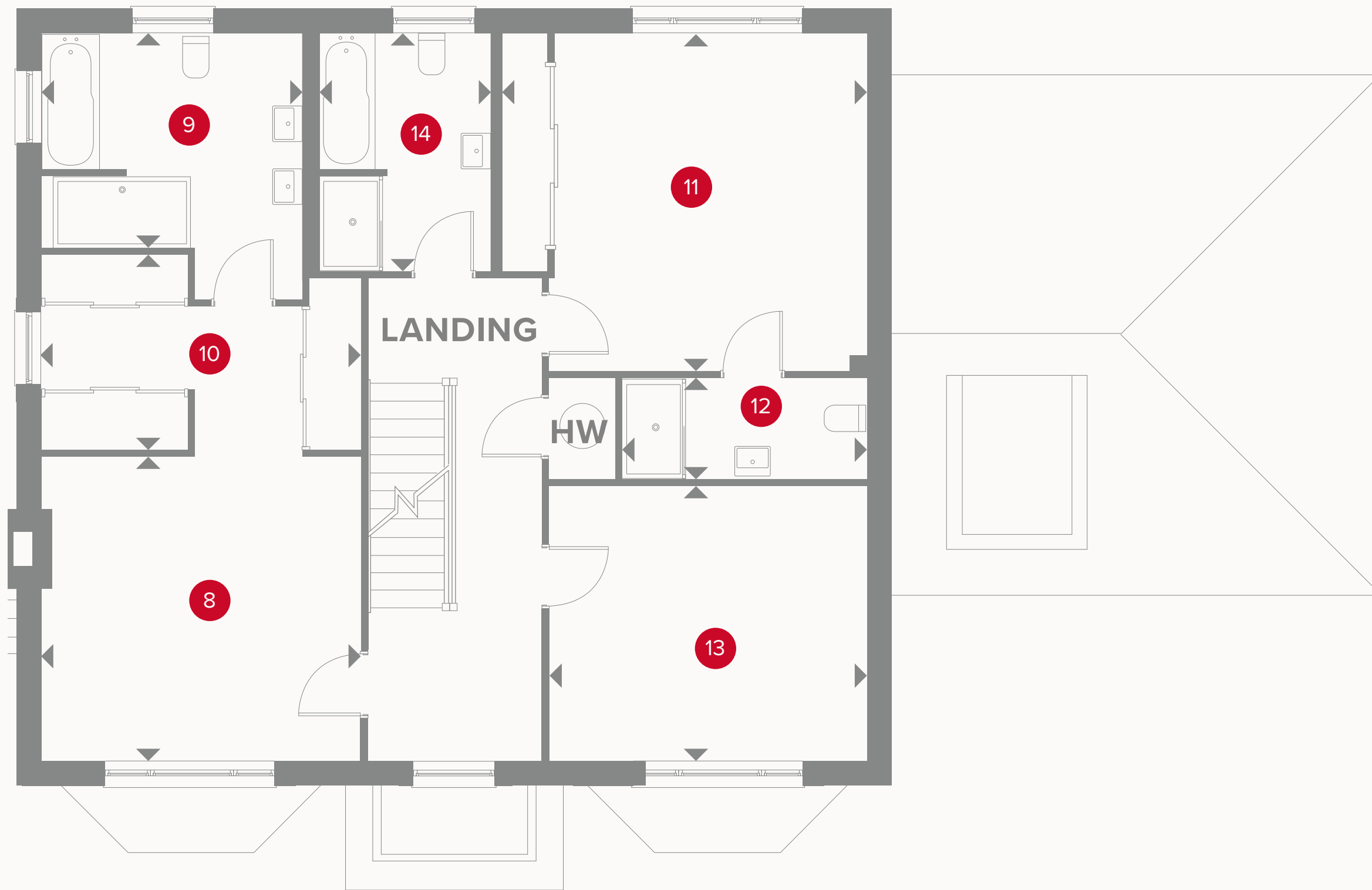

8	Bedroom 1	12'7" x 12'5"	3.86 x 3.81 m
9	En-suite 1	10'8" x 8'9"	3.27 x 2.70 m
10	Dressing	10'8" x 8'0"	3.29 x 2.45 m
11	Bedroom 2	15'0" x 14'0"	4.58 x 4.25 m
12	En-suite 2	10'0" x 4'1"	3.07 x 1.25 m
13	Bedroom 3	13'0" x 11'2"	3.98 x 3.43 m
14	Bathroom	10'0" x 7'0"	2.98 x 2.14 m



KEY

HW Hot water storage

THE CRANFORD SECOND FLOOR



15	Bedroom 4/ Media Room	15'0" x 12'7"	4.59 x 3.86 m
16	Bedroom 5	16'8" x 8'2"	5.12 x 2.51 m
17	Shower Room	7'9" x 6'6"	2.39 x 1.99 m



KEY

- ◀ Dimensions start
- LH Loft Hatch
- ST Storage cuboard

**CONSUMER
CODE FOR
HOME BUILDERS**
www.consumercode.co.uk

Customers should note this illustration is an example of the Tatton house type. All dimensions indicated are approximate and the furniture layout is for illustrative purposes only. Homes may be 'handed' (mirror image) versions of the illustrations, and may be detached, semi-detached or terraced. Materials used may differ from plot to plot including render and roof tile colours. Detailed plans and specifications are available for inspection for each plot at our Sales Centre during working hours and customers must check their individual specifications prior to making a reservation.