



INSPIRED

- REDROW -

THE TATTON

FIVE BEDROOM HOME

 **REDROW**

THE TATTON GROUND FLOOR

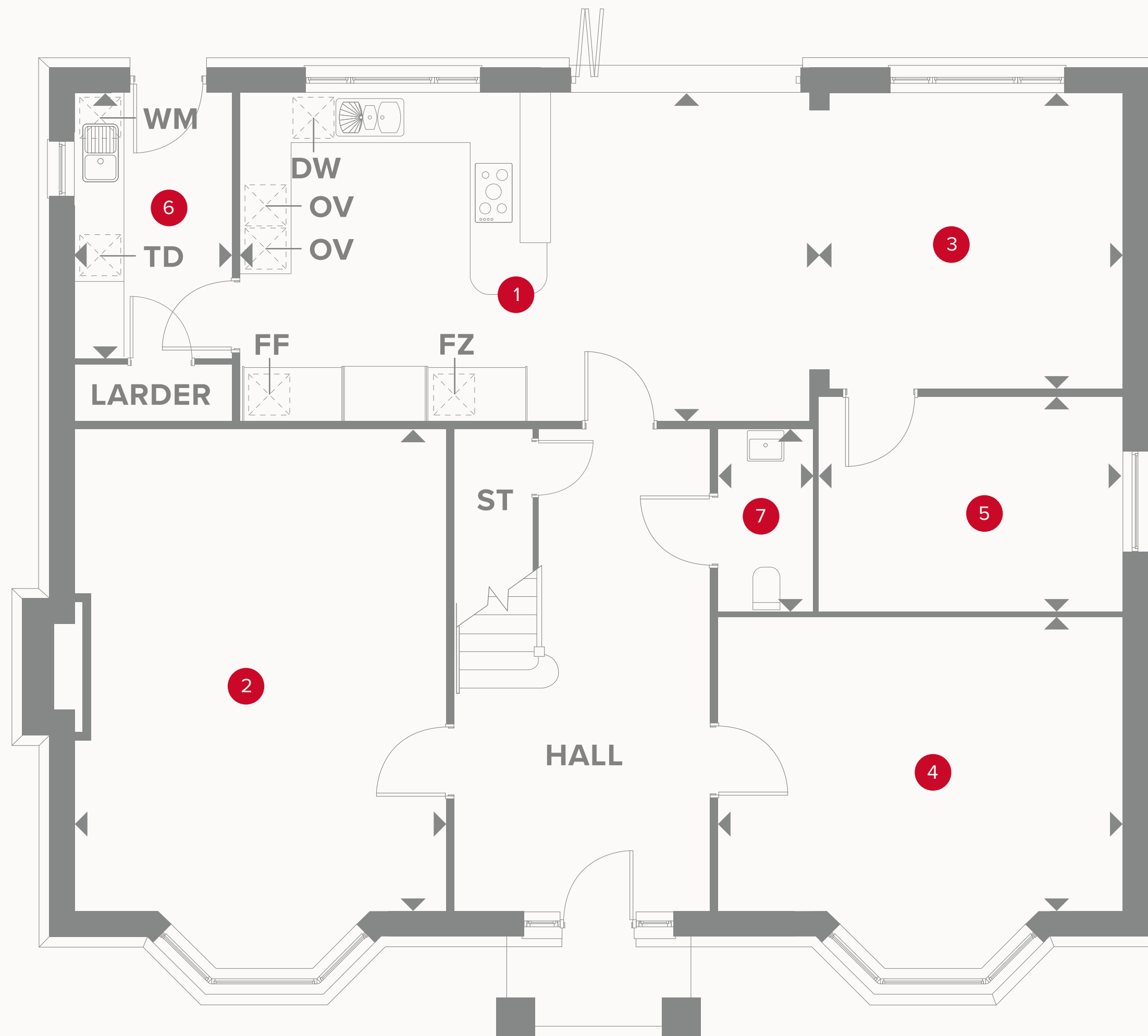

1	Kitchen/Breakfast	22'8" x 13'1"	6.93 x 4.00 m
2	Lounge	19'3" x 14'9"	5.89 x 4.53 m
3	Family	11'9" x 11'8"	3.60 x 3.57 m
4	Dining	16'2" x 11'9"	4.94 x 3.60 m
5	Study	12'7" x 8'4"	3.87 x 2.59 m
6	Utility	10'7" x 6'2"	3.25 x 1.90 m
7	Cloaks	7'2" x 3'8"	2.20 x 1.13 m



KEY

- Hob
- OV** Oven
- FR** Fridge
- FZ** Freezer
- TD** Tumble dryer space

- Dimensions start
- ST** Storage cupboard
- WM** Washing machine space
- DW** Dish washer space



THE TATTON FIRST FLOOR

8	Bedroom 1	14'8" x 14'6"	4.50 x 4.44 m
9	En-suite 1	11'0" x 10'0"	3.38 x 3.07 m
10	Dressing	11'3" x 7'4"	3.47 x 2.26 m
11	Bedroom 2	13'6" x 11'7"	4.14 x 3.55 m
12	En-suite 2	8'9" x 4'1"	2.69 x 1.25 m
13	Bedroom 3	13'0" x 10'1"	3.99 x 3.10 m
14	En-suite 3	8'9" x 4'1"	2.69 x 1.25 m
15	Bedroom 4	13'3" x 11'8"	4.06 x 3.59 m
16	Bedroom 5	11'1" x 9'8"	3.40 x 2.98 m
17	Bathroom	9'8" x 6'8"	2.98 x 2.07 m



KEY

- ◀ Dimensions start
- HW** Hot water storage
- ST** Storage cupboard
- LH** Loft hatch

**CONSUMER
CODE FOR
HOME BUILDERS**

www.consumercode.co.uk

Customers should note this illustration is an example of the Tatton house type. All dimensions indicated are approximate and the furniture layout is for illustrative purposes only. Homes may be 'handed' (mirror image) versions of the illustrations, and may be detached, semi-detached or terraced. Materials used may differ from plot to plot including render and roof tile colours. Detailed plans and specifications are available for inspection for each plot at our Sales Centre during working hours and customers must check their individual specifications prior to making a reservation.