



INSPIRED

- REDROW -

THE BLACKHILL

THREE BEDROOM HOME

 **REDROW**

THE BLACKHILL GROUND FLOOR

1	Kitchen/Dining	16'0" x 11'0"	4.81 x 3.27m
2	Lounge	15'0" x 12'0"	4.66 x 3.61m
3	Cloaks	5'0" x 4'0"	1.60 X 1.11m

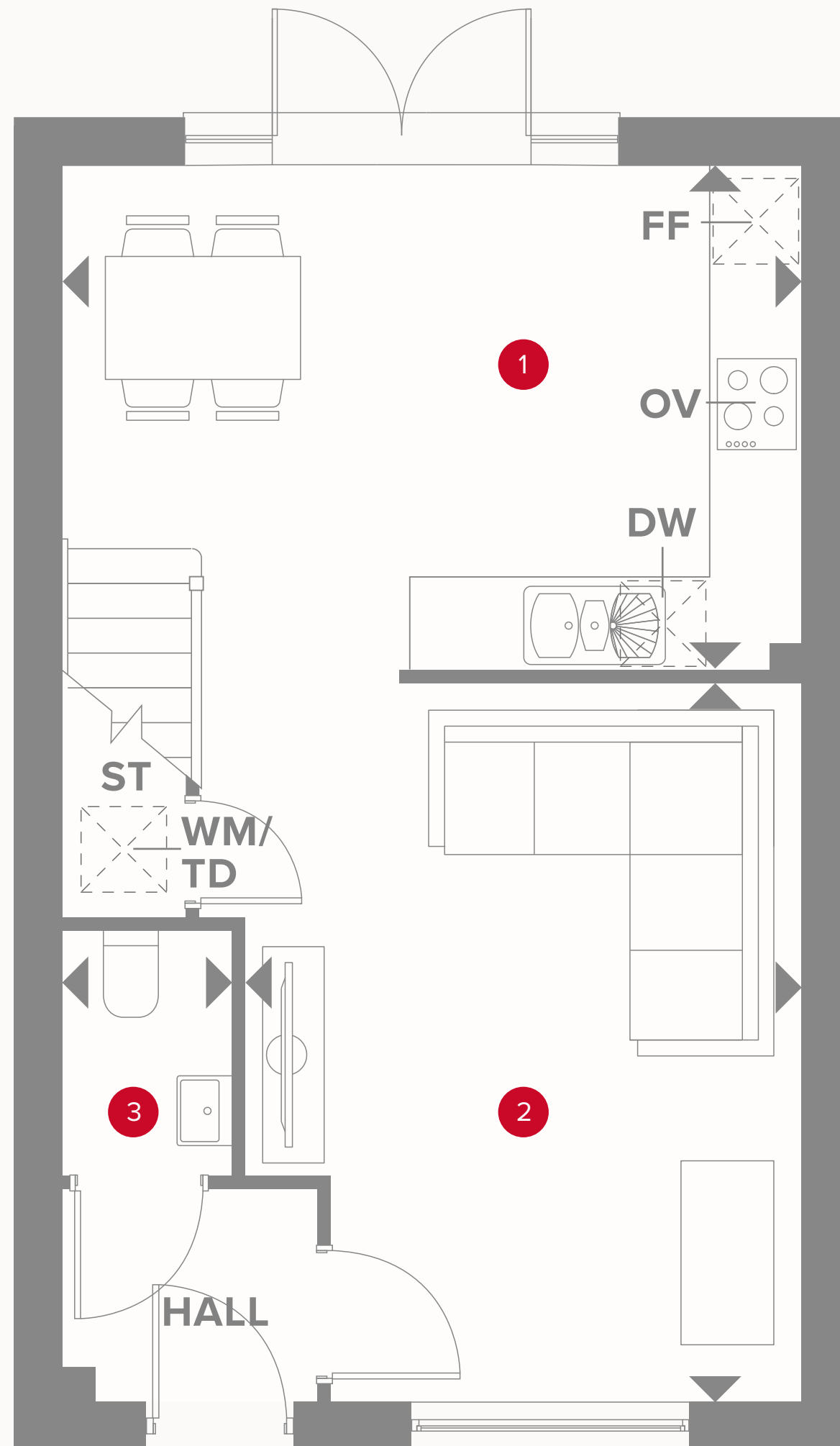

KEY

-  Hob
- OV** Oven
- FF** Fridge/freezer
- TD** Tumble dryer space

-  Dimensions start
- ST** Storage cupboard
- WM** Washing machine space
- DW** Dish washer space

THE BLACKHILL FIRST FLOOR

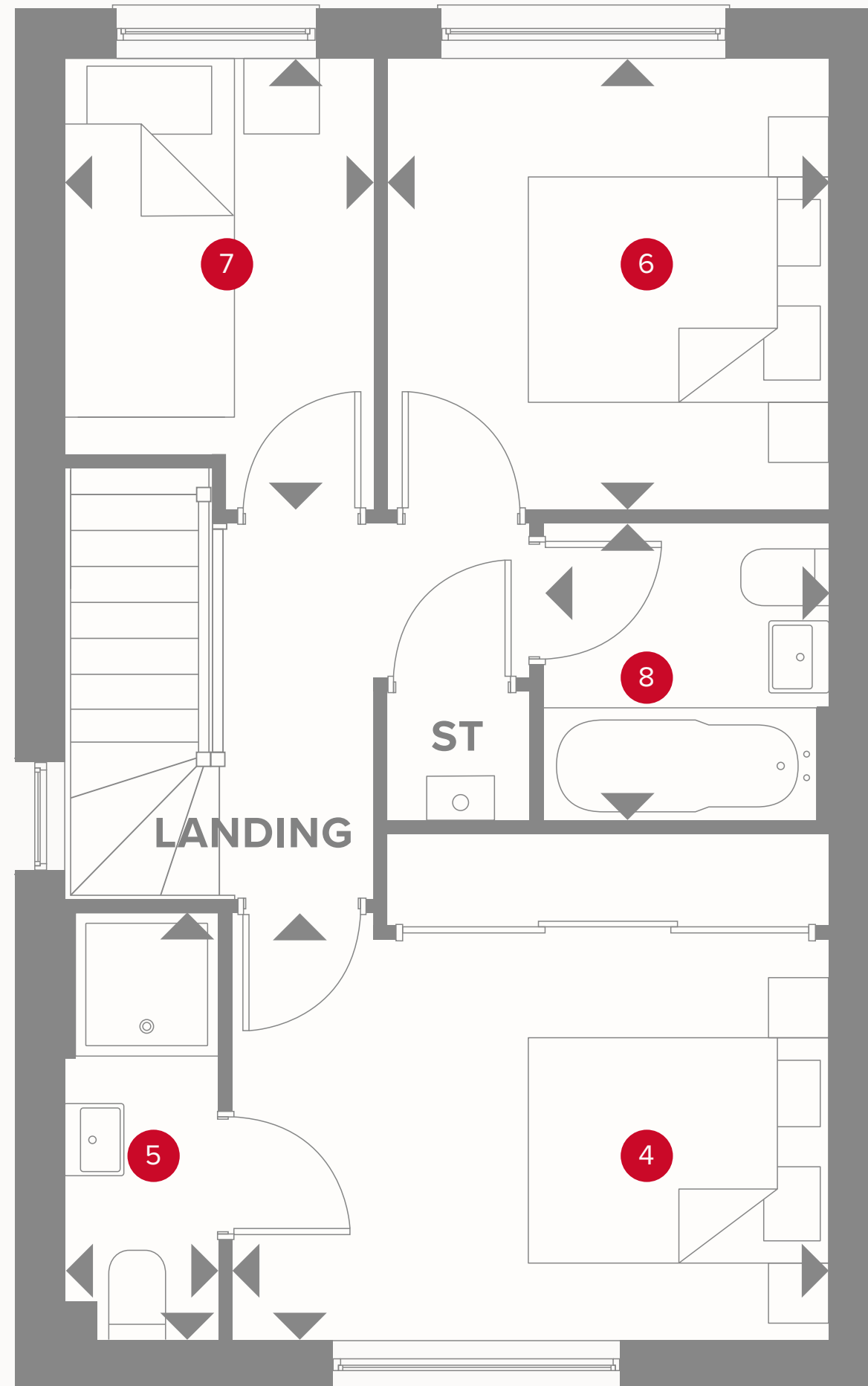

4	Bedroom 1	12'0" x 10'0"	3.75 X 3.17m
5	En-suite 1	8'0" x 3'0"	2.68 X 0.97m
6	Bedroom 2	9'0" x 6'4"	2.80 X 1.96m
7	Bedroom 3	9'0" x 9'0"	2.80 X 2.77m
8	Bathroom	6'0" x 6'0"	1.87 X 1.78m



KEY

- ◀ Dimensions start
- HW Hot water storage
- LH Loft hatch

**CONSUMER
CODE FOR
HOME BUILDERS**
www.consumercode.co.uk

Customers should note this illustration is an example of the Blackhill house type. All dimensions indicated are approximate and the furniture layout is for illustrative purposes only. Homes may be 'handed' (mirror image) versions of the illustrations, and may be detached, semi-detached or terraced. Materials used may differ from plot to plot including render and roof tile colours. Detailed plans and specifications are available for inspection for each plot at our Sales Centre during working hours and customers must check their individual specifications prior to making a reservation.