



HERITAGE

- REDROW -

THE HARROGATE

FOUR BEDROOM DETACHED HOME

 **REDROW**

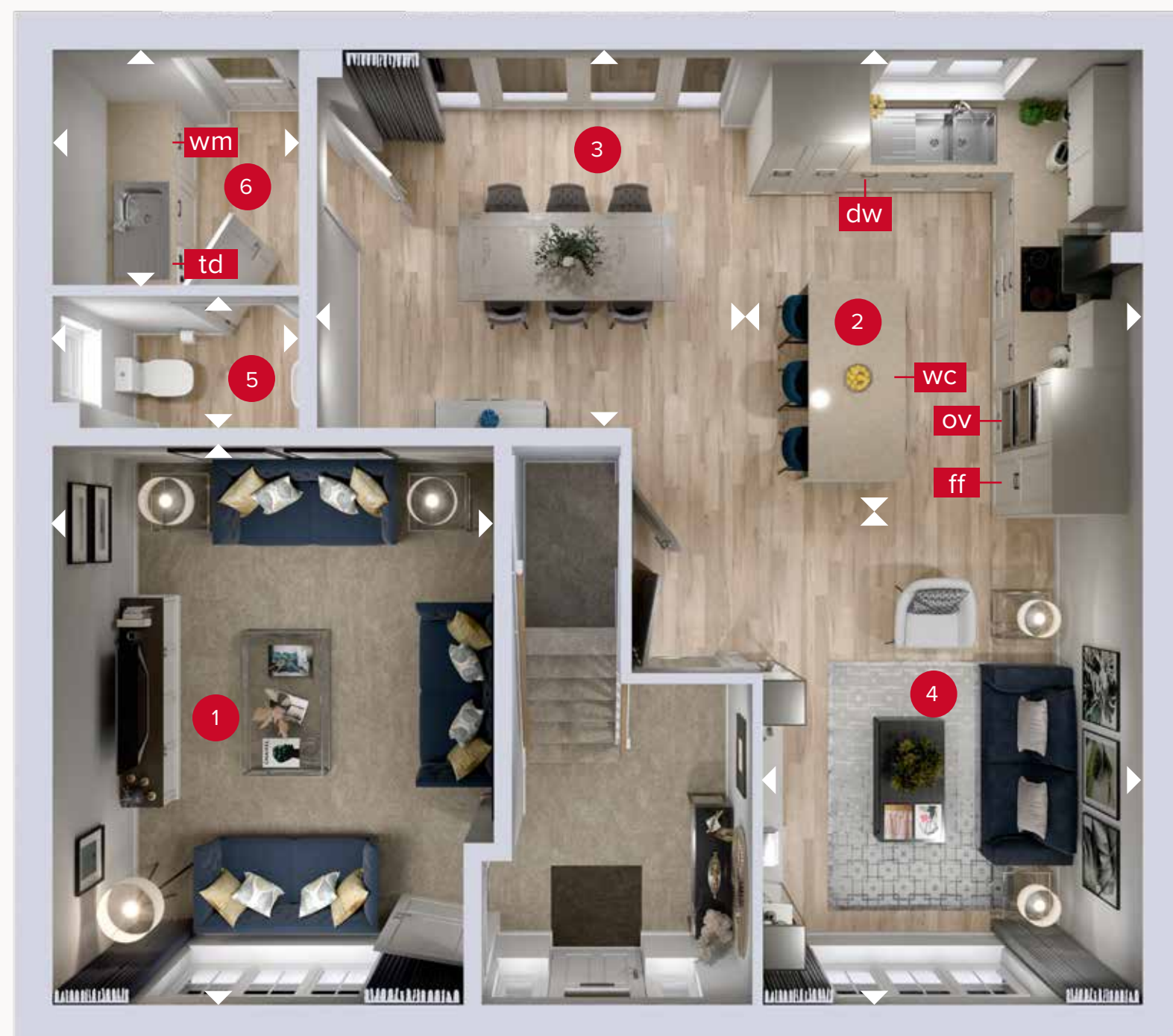

GROUND FLOOR

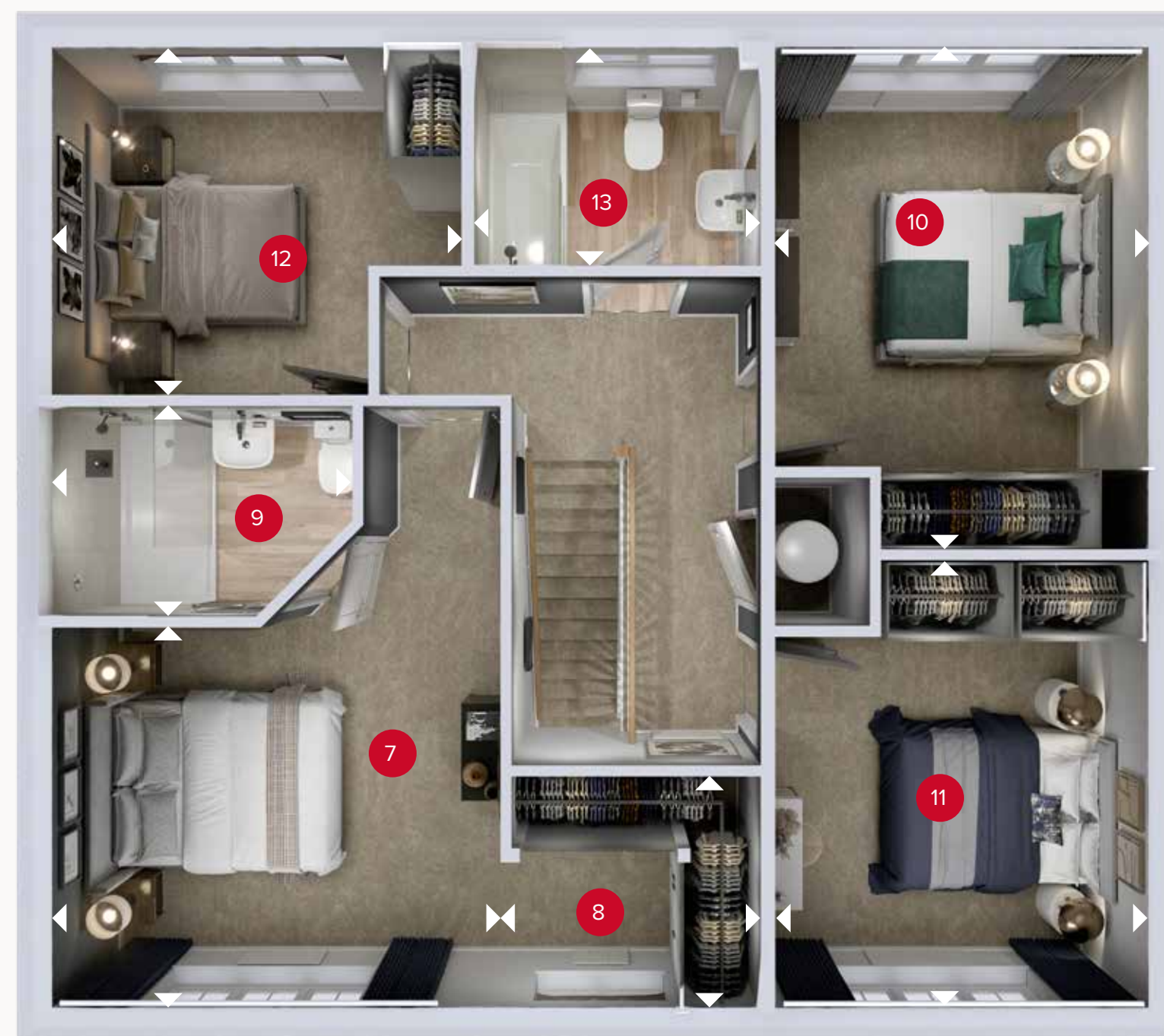

FIRST FLOOR

THE HARROGATE

GROUND FLOOR

| | | | |
|---|---------|---------------|---------------|
| 1 | Lounge | 15'4" x 12'0" | 4.68 x 3.65 m |
| 2 | Kitchen | 12'5" x 10'1" | 3.79 x 3.09 m |
| 3 | Dining | 13'1" x 10'3" | 4.00 x 3.13 m |
| 4 | Family | 13'8" x 10'1" | 4.17 x 3.08 m |
| 5 | Cloaks | 5'8" x 3'7" | 1.73 x 1.10 m |
| 6 | Utility | 6'4" x 5'8" | 1.94 x 1.73 m |

FIRST FLOOR

| | | | |
|----|-----------|----------------|---------------|
| 7 | Bedroom 1 | 12'2" x 10'10" | 3.72 x 3.30 m |
| 8 | Dressing | 6'7" x 6'5" | 2.00 x 1.96 m |
| 9 | En-suite | 8'2" x 5'7" | 2.48 x 1.69 m |
| 10 | Bedroom 2 | 13'9" x 10'0" | 4.18 x 3.05 m |
| 11 | Bedroom 3 | 12'1" x 10'0" | 3.69 x 3.05 m |
| 12 | Bedroom 4 | 11'2" x 9'2" | 3.40 x 2.79 m |
| 13 | Bathroom | 7'7" x 5'9" | 2.31 x 1.76 m |