



HERITAGE

- REDROW -

# THE SHAFTESBURY

FOUR BEDROOM DETACHED  
ECO ELECTRIC HOME







HERITAGE

- REDROW -

# THE SHAFTESBURY

FOUR BEDROOM DETACHED  
ECO ELECTRIC HOME







GROUND FLOOR

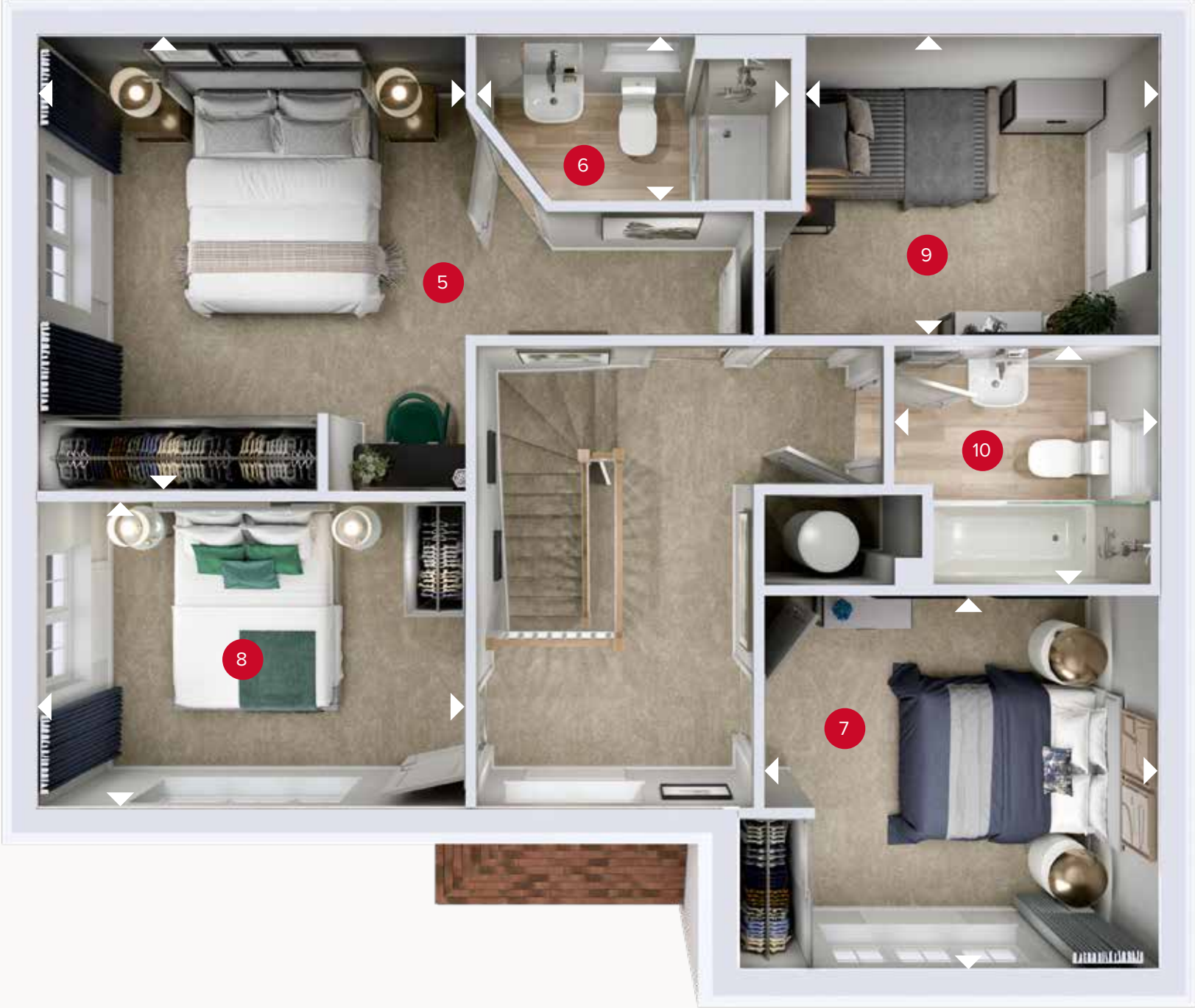

FIRST FLOOR

# THE SHAFTESBURY

## GROUND FLOOR

1	Kitchen/Dining/ Family	25'4" x 11'8"	7.73 x 3.57 m
2	Lounge	20'11" x 11'8"	6.38 x 3.56 m
3	Cloaks	6'6" x 3'2"	1.99 x 0.97 m
4	Utility	6'6" x 5'10"	1.99 x 1.79 m

## FIRST FLOOR

5	Bedroom 1	12'3" x 11'11"	3.74 x 3.62 m
6	En-suite	8'6" x 4'5"	2.58 x 1.35 m
7	Bedroom 2	11'0" x 10'0"	3.35 x 3.05 m
8	Bedroom 3	11'11" x 8'4"	3.62 x 2.55 m
9	Bedroom 4	9'10" x 8'1"	3.01 x 2.45 m
10	Bathroom	7'5" x 6'9"	2.26 x 2.05 m