



HERITAGE

- REDROW -

THE LUDLOW

THREE BEDROOM HOME

 **REDROW**



HERITAGE

- REDROW -

THE LUDLOW

THREE BEDROOM HOME

 **REDROW**



HERITAGE

- REDROW -

THE LUDLOW

THREE BEDROOM HOME

 **REDROW**



HERITAGE

- REDROW -

THE LUDLOW

THREE BEDROOM HOME

 **REDROW**

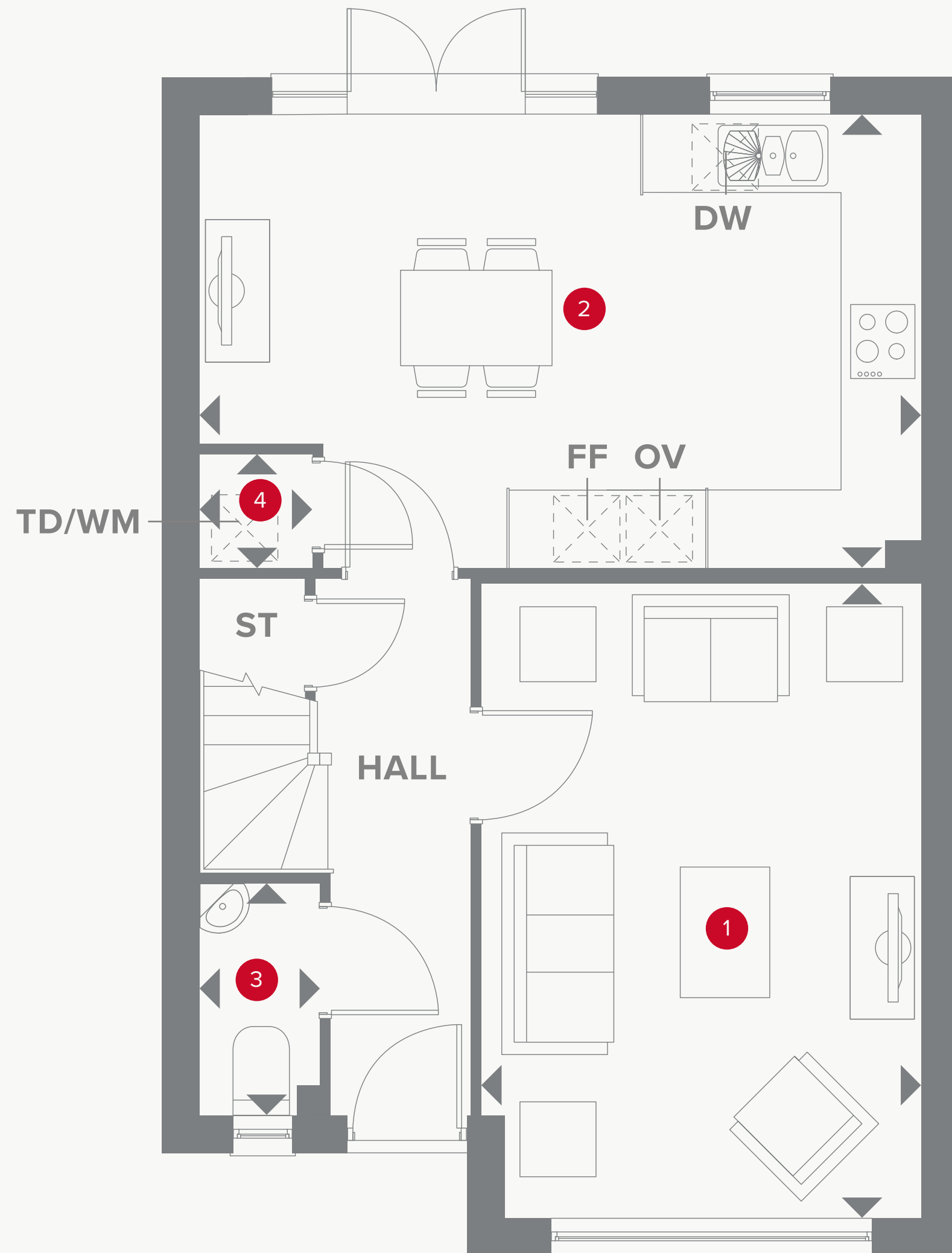

THE LUDLOW GROUND FLOOR

1	Lounge	15'11" x 11'0"	4.84 x 3.35 m
2	Kitchen	18'2" x 11'5"	5.53 x 3.48 m
3	Cloaks	2'11" x 2'9"	0.90 x 0.85 m
4	Laundry	5'9" x 2'11"	1.76 x 0.90 m



KEY

	Hob
OV	Oven
FF	Fridge/freezer
	Dimensions start

ST	Storage cupboard
DW	Dish washer space
TD/WM	Tumble Drier/Washing Machine Space

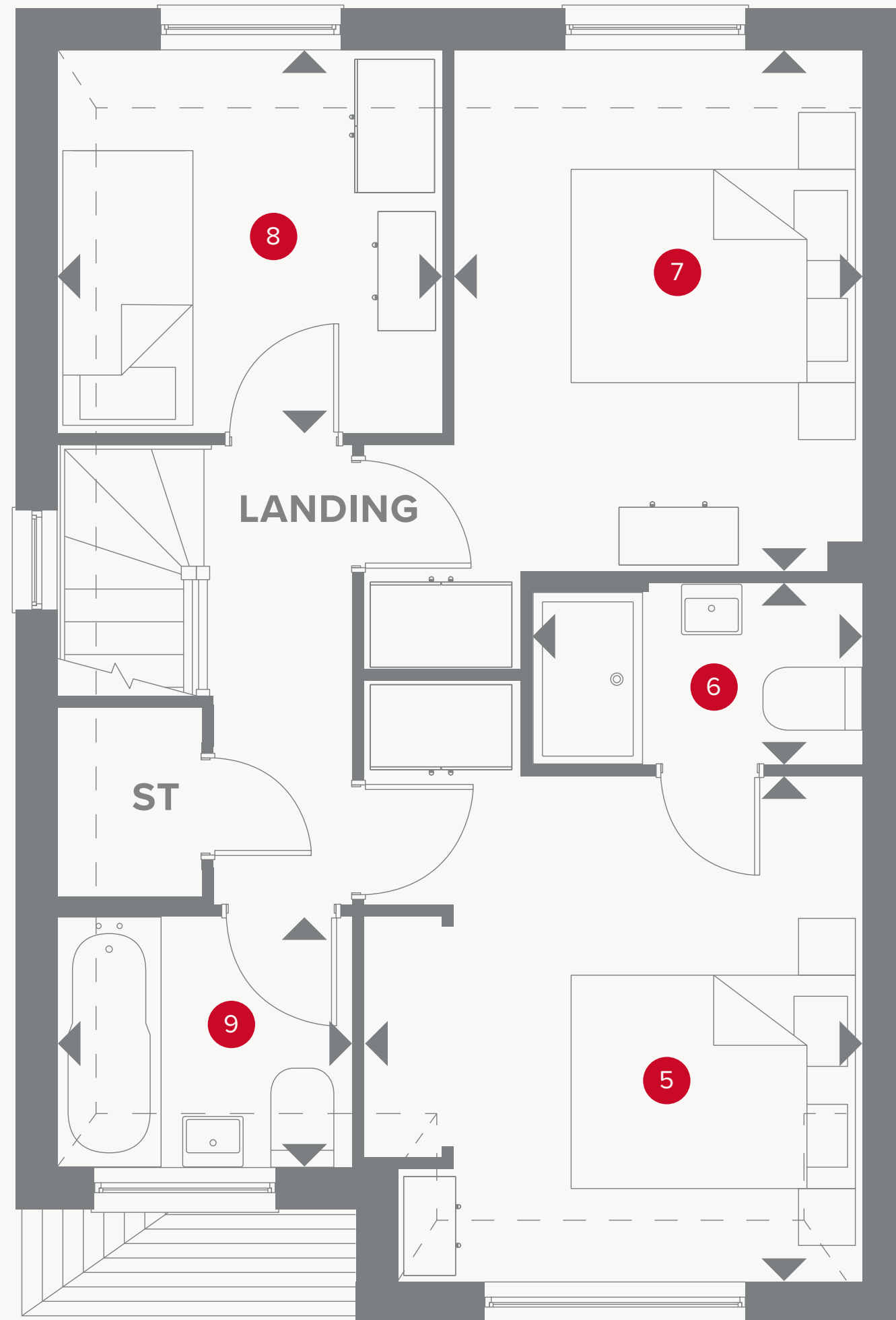

THE LUDLOW FIRST FLOOR

5	Bedroom 1	11'5" x 11'3"	3.47 x 3.42 m
6	En-suite	7'5" x 4'1"	2.26 x 1.25 m
7	Bedroom 2	11'9" x 9'3"	3.58 x 2.81 m
8	Bedroom 3	8'8" x 8'7"	2.64 x 2.62 m
9	Bathroom	6'8" x 5'7"	2.02 x 1.71 m



KEY

- ◀ Dimensions start
- ST Storage cupboard

**CONSUMER
CODE FOR
HOME BUILDERS**
www.consumercode.co.uk

Customers should note this illustration is an example of the Harrogate house type. All dimensions indicated are approximate and the furniture layout is for illustrative purposes only. Homes may be 'handed' (mirror image) versions of the illustrations, and may be detached, semi-detached or terraced. Materials used may differ from plot to plot including render and roof tile colours. Detailed plans and specifications are available for inspection for each plot at our Sales Centre during working hours and customers must check their individual specifications prior to making a reservation.