

# THE HIGHGROVE

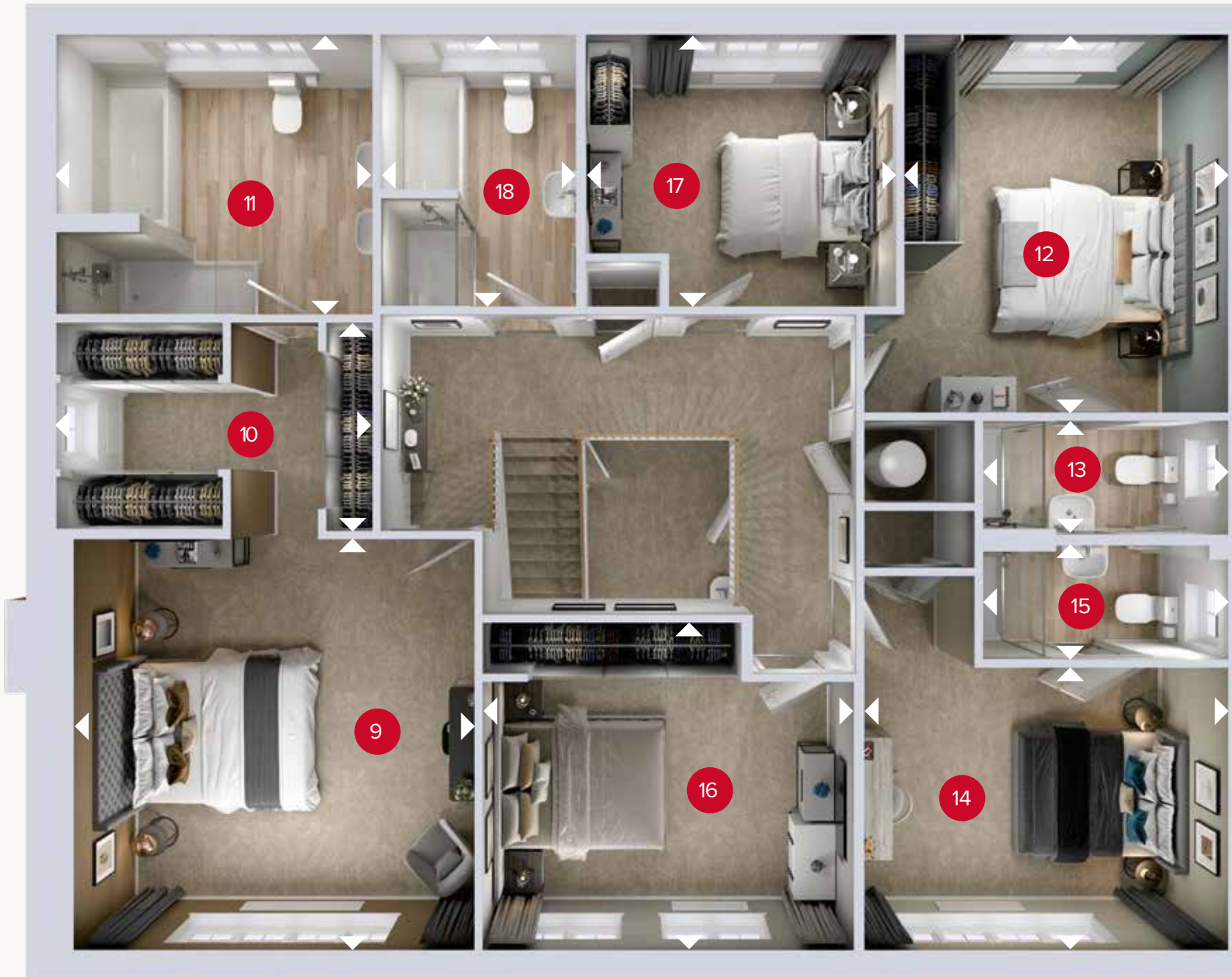

**GROUND FLOOR**



**FIRST FLOOR**

## GROUND FLOOR

1	Kitchen/Breakfast	23'9" x 13'5"	7.24 x 4.08 m
2	Family	12'1" x 11'7"	3.68 x 3.54 m
3	Lounge	19'3" x 14'8"	5.86 x 4.47 m
4	Dining	16'1" x 11'9"	4.90 x 3.57 m
5	Study	12'1" x 8'6"	3.69 x 2.60 m
6	Utility	10'11" x 6'2"	3.33 x 1.87 m
7	Larder	6'2" x 2'2"	1.87 x 0.66 m
8	Cloaks	7'3" x 3'8"	2.20 x 1.13 m

## FIRST FLOOR

9	Bedroom 1	15'0" x 14'4"	4.56 x 4.38 m
10	Dressing Room	11'3" x 7'5"	3.42 x 2.26 m
11	En-suite 1	11'3" x 10'0"	3.44 x 3.06 m
12	Bedroom 2	13'11" x 11'7"	4.23 x 3.52 m
13	En-suite 2	8'9" x 4'1"	2.66 x 1.25 m
14	Bedroom 3	13'0" x 10'1"	3.96 x 3.07 m
15	En-suite 3	8'9" x 4'1"	2.66 x 1.25 m
16	Bedroom 4	13'5" x 11'8"	4.10 x 3.56 m
17	Bedroom 5	11'2" x 10'0"	3.41 x 3.06 m
18	Bathroom	10'0" x 7'0"	3.06 x 2.13 m



**NEW HOMES QUALITY CODE**

26.05.2023

Customers should note this illustration is an example of the Highgrove house type. All dimensions indicated are approximate and the furniture layout is for illustrative purposes only. Homes may be 'handed' (mirror image) versions of the illustrations, and may be detached, semi-detached or terraced. Materials used may differ from plot to plot including render and roof tile colours. Detailed plans and specifications are available for inspection for each plot at our Customer Experience Suite or Sales Centre during working hours and customers must check their individual specifications prior to making a reservation. Please note that the specification shown in this plan may include optional upgrades from standard specification. Please speak with your Sales Consultant or visit MyRedrow for more information. 03032-03 EG\_HIGHP\_DM.2

▷ Denotes where dimensions are taken from. All wardrobes are subject to site specification. Please see Sales Consultant for further details.

ov - oven  
fr - fridge  
fz - freezer  
dw - dishwasher  
wm - washing machine space  
td - tumble dryer space  
mc - microwave  
wc - wine cooler  
so - steam oven

