

**GROUND FLOOR**

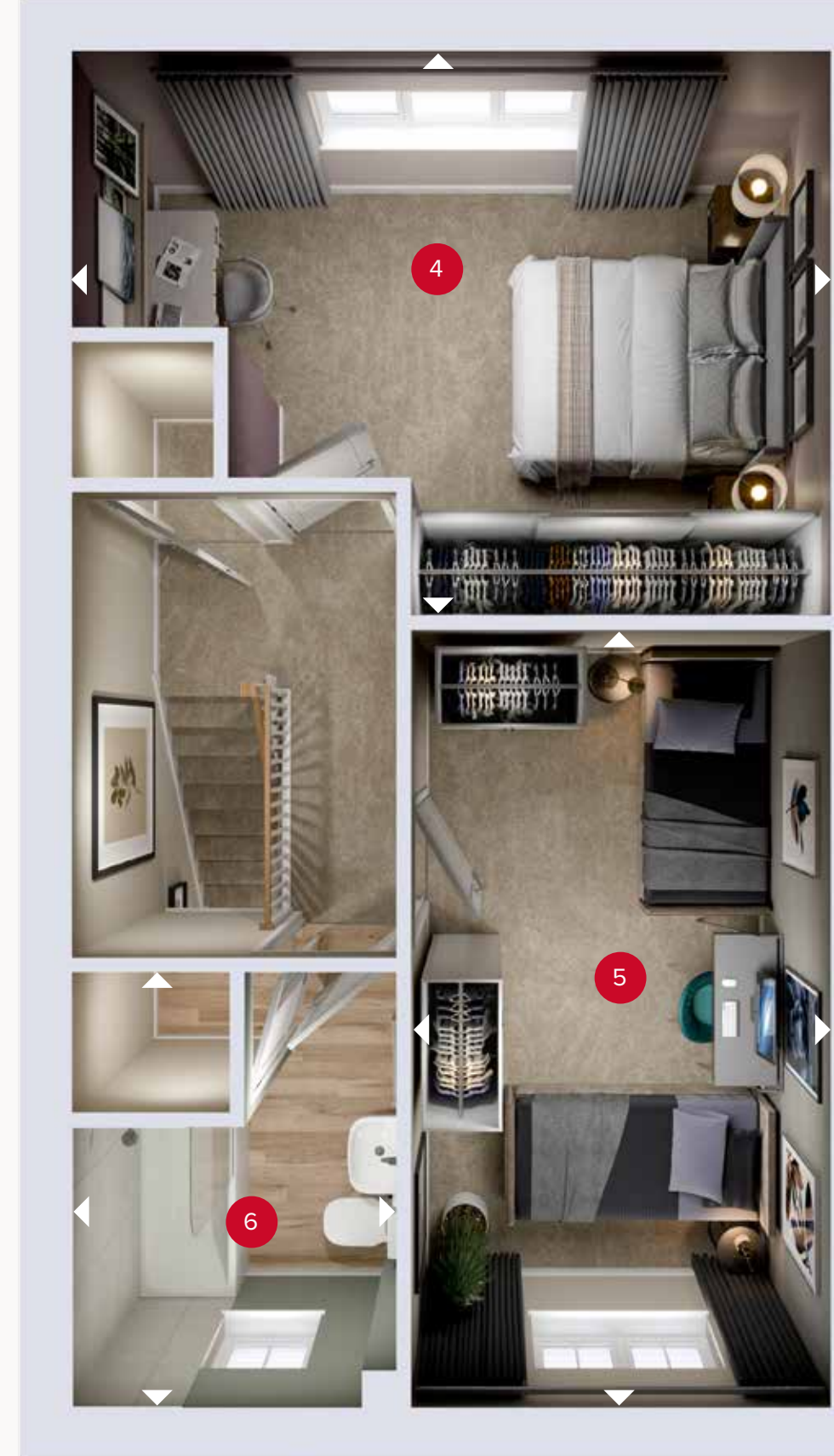

**FIRST FLOOR**

# THE TAVY MID

## GROUND FLOOR

1 Lounge/Dining	15'1" x 14'0"	4.60 x 4.26 m
2 Kitchen	8'11" x 8'4"	2.73 x 2.55 m
3 Cloaks	7'6" x 3'4"	2.29 x 1.02 m

## FIRST FLOOR

4 Bedroom 1	15'1" x 11'0"	4.60 x 3.36 m
5 Bedroom 2	15'6" x 8'4"	4.73 x 2.55 m
6 Bathroom	8'8" x 6'5"	2.65 x 1.96 m