



Plots 26, 35, 45, 57 & 66

TAILORED
- REDROW -

THE ALKHAM

THREE BEDROOM DETACHED HOME





Plots 26, 35, 45, 57 & 66

TAILORED
- REDROW -

THE ALKHAM

THREE BEDROOM DETACHED HOME





Plots 26, 35, 45, 57 & 66

TAILORED
- REDROW -

THE ALKHAM

THREE BEDROOM DETACHED HOME



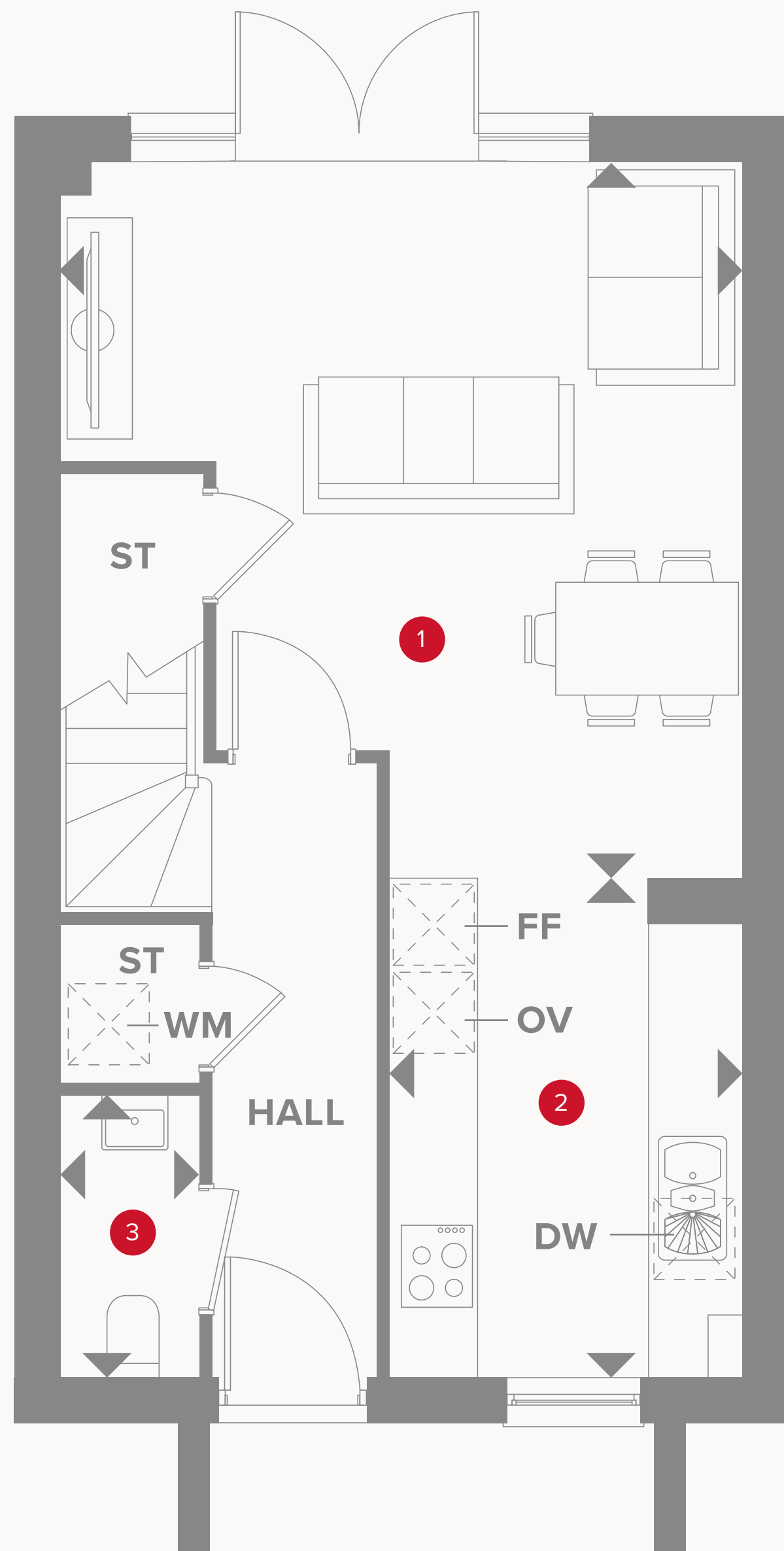



THE ALKHAM GROUND FLOOR

| | | | |
|---|---------------|---------------|---------------|
| 1 | Family/Dining | 15'8" x 15'2" | 4.83 x 4.65 m |
| 2 | Kitchen | 11'1" x 7'10" | 3.40 x 2.40 m |
| 3 | Cloaks | 6'2" x 3'0" | 1.91 x 0.94 m |



KEY

-  Hob
- FF** Fridge/freezer
-  Dimensions start

- ST** Storage cupboard
- DW** Optional Dish washer space
- OV** Oven space
- WM** Washing machine space

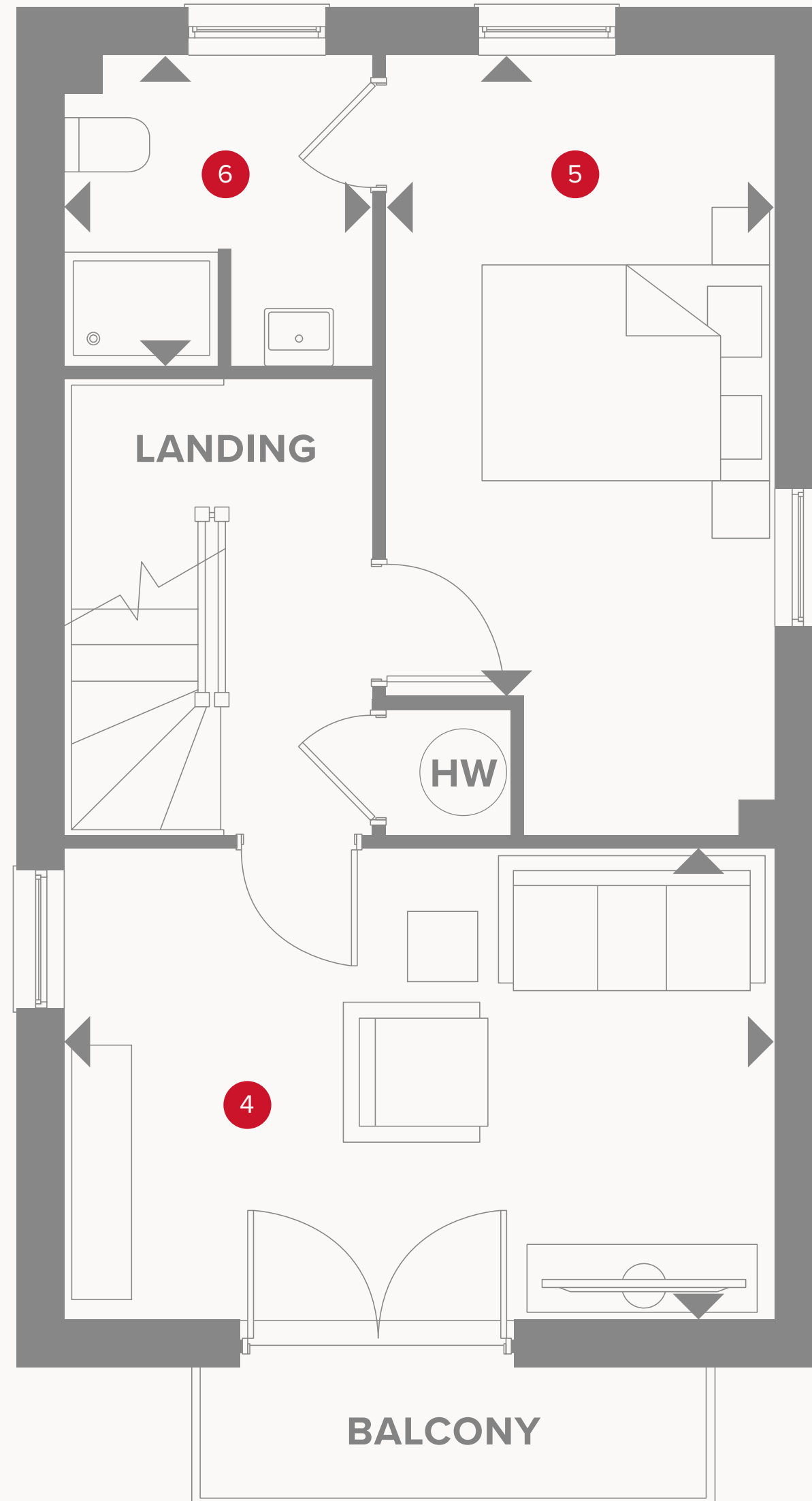

THE ALKHAM FIRST FLOOR

| | | | |
|---|-------------|---------------|---------------|
| 4 | Living Room | 15'2" x 10'1" | 4.65 x 3.08 m |
| 5 | Bedroom 2 | 13'6" x 8'3" | 4.15 x 2.54 m |
| 6 | En-suite 2 | 6'6" x 6'4" | 2.02 x 1.98 m |



KEY

- ◀ Dimensions start
- HW Hot water cylinder

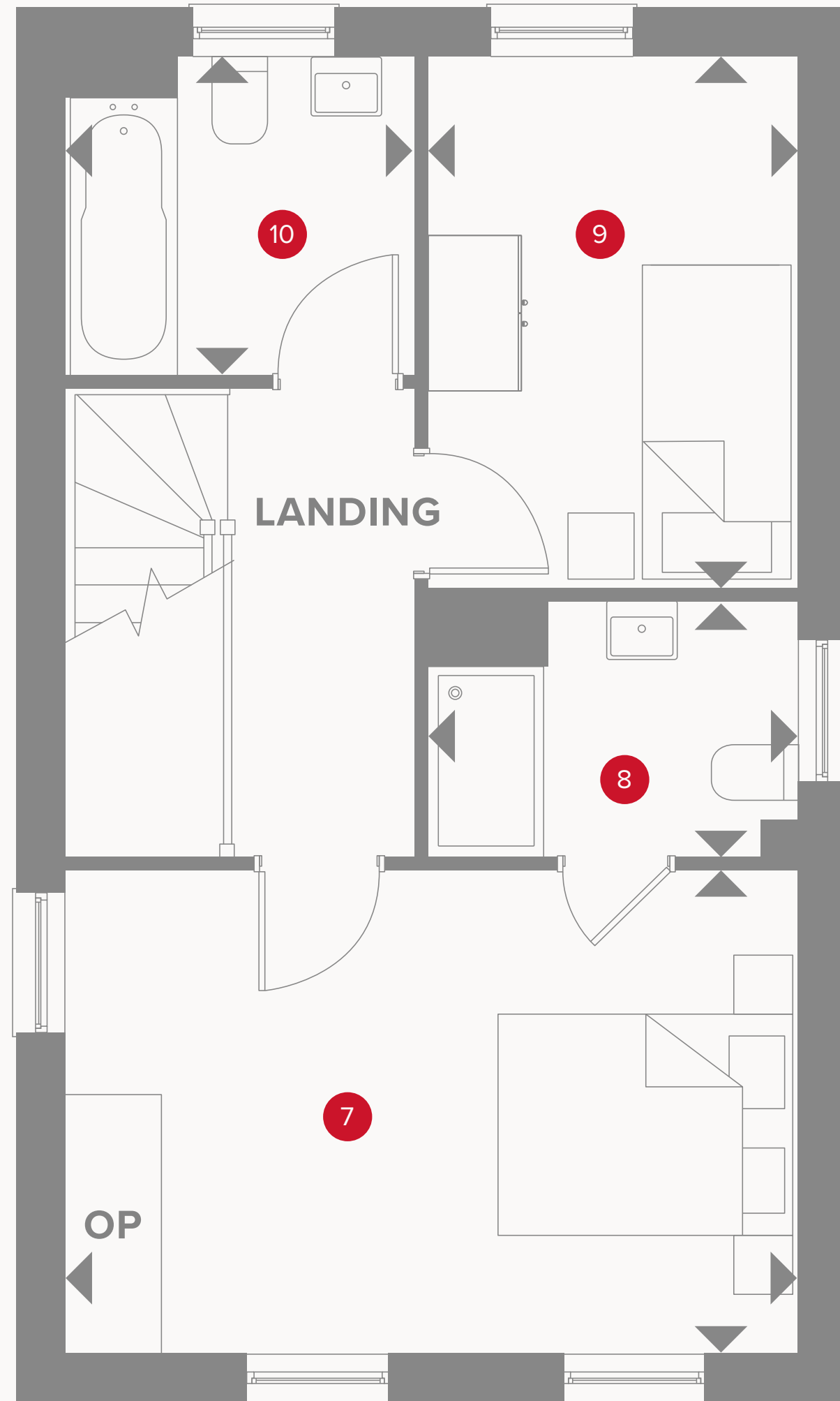

*No window to plots 45 & 47

THE ALKHAM SECOND FLOOR

| | | | |
|----|------------|---------------|---------------|
| 7 | Bedroom 1 | 15'2" x 10'1" | 4.65 x 3.08 m |
| 8 | En-suite 1 | 7'6" x 5'3" | 2.34 x 1.63 m |
| 9 | Bedroom 3 | 10'9" x 7'6" | 3.35 x 2.34 m |
| 10 | Bathroom | 7'2" x 6'4" | 2.22 x 1.98 m |



Customers should note this illustration is an example of the Alkham house type. All dimensions indicated are approximate and the furniture layout is for illustrative purposes only. Homes may be 'handed' (mirror image) versions of the illustrations, and may be detached, semi-detached or terraced. Materials used may differ from plot to plot including render and roof tile colours. Detailed plans and specifications are available for inspection for each plot at our Customer Experience Suite or Sales Centre during working hours and customers must check their individual specifications prior to making a reservation. Please note that the specification show in this plan may include optional upgrades from standard specification. Please speak with your Sales Consultant or visit MyRedrow for more information.

KEY

- ◀ Dimensions start
- OP Optional wardrobe