



HERITAGE

- REDROW -

THE WINDSOR

FOUR BEDROOM DETACHED HOME

 **REDROW**



HERITAGE

- REDROW -

THE WINDSOR

FOUR BEDROOM DETACHED HOME

 **REDROW**

THE WINDSOR GROUND FLOOR

1	Lounge	11'3" x 10'11"	3.43 x 3.33 m
2	Kitchen/Dining	18'4" x 15'10"	5.59 x 4.83 m
3	Cloaks	5'7" x 3'1"	1.69 x 0.94 m
4	Utility	7'3" x 6'5"	2.22 x 1.95 m
5	Garage	19'8" x 9'10"	5.99 x 3.00 m



KEY

-  Hob
- OV** Oven
- FF** Fridge/freezer
- TD** Tumble dryer space

-  Dimensions start
- ST** Storage cupboard
- WM** Washing machine space
- DW** Dish washer space

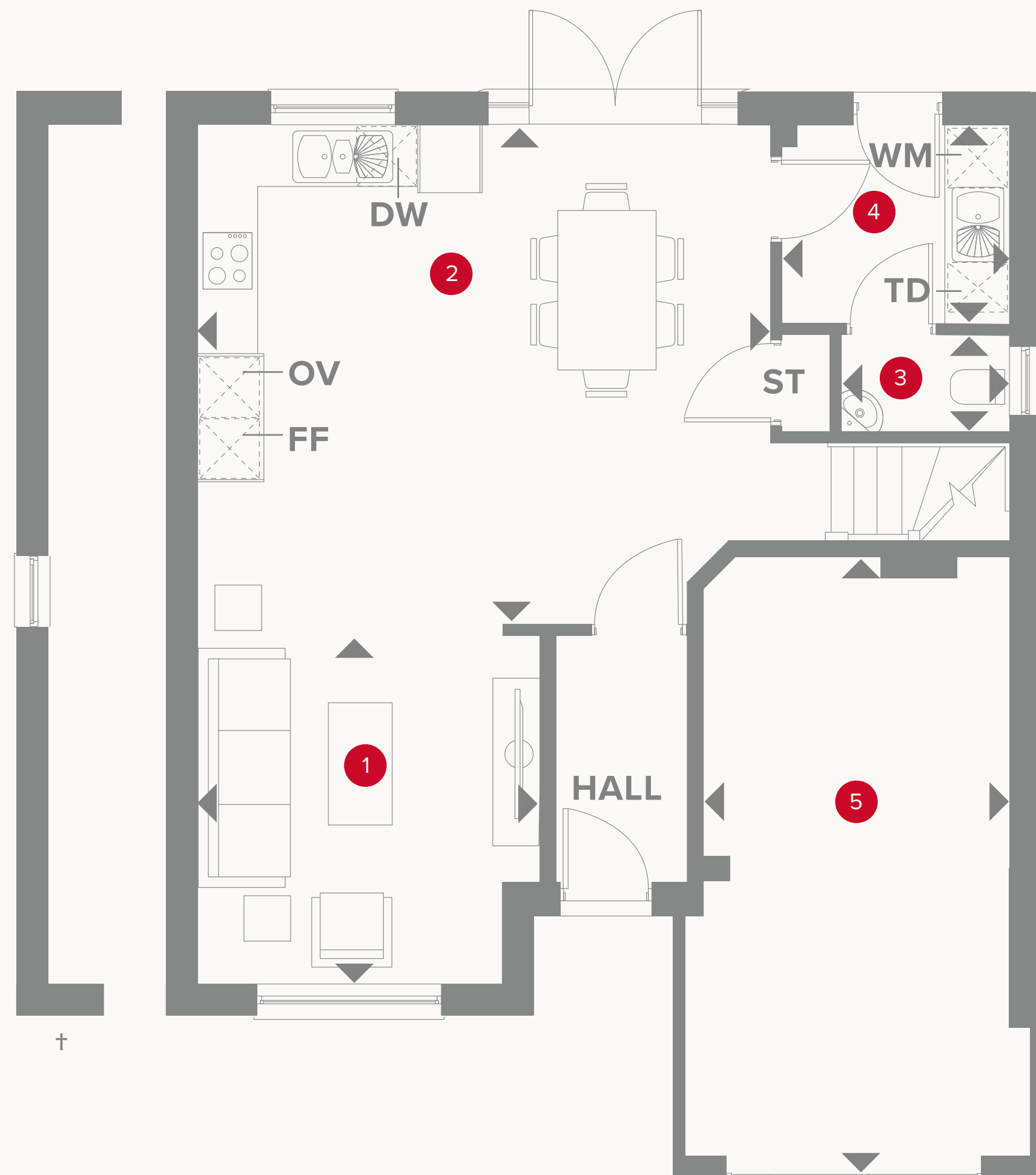

† Denotes alternative elevation

THE WINDSOR FIRST FLOOR

6	Bedroom 1	16'10" x 9'9"	5.14 x 2.96 m
7	En-suite	8'2" x 4'3"	2.48 x 1.29 m
8	Bedroom 2	10'3" x 9'8"	3.12 x 2.94 m
9	Bedroom 3	9'11" x 8'11"	3.01 x 2.72 m
10	Study/Bedroom 4	11'5" x 7'1"	3.48 x 2.17 m
11	Bathroom	6'9" x 6'4"	2.07 x 1.94 m

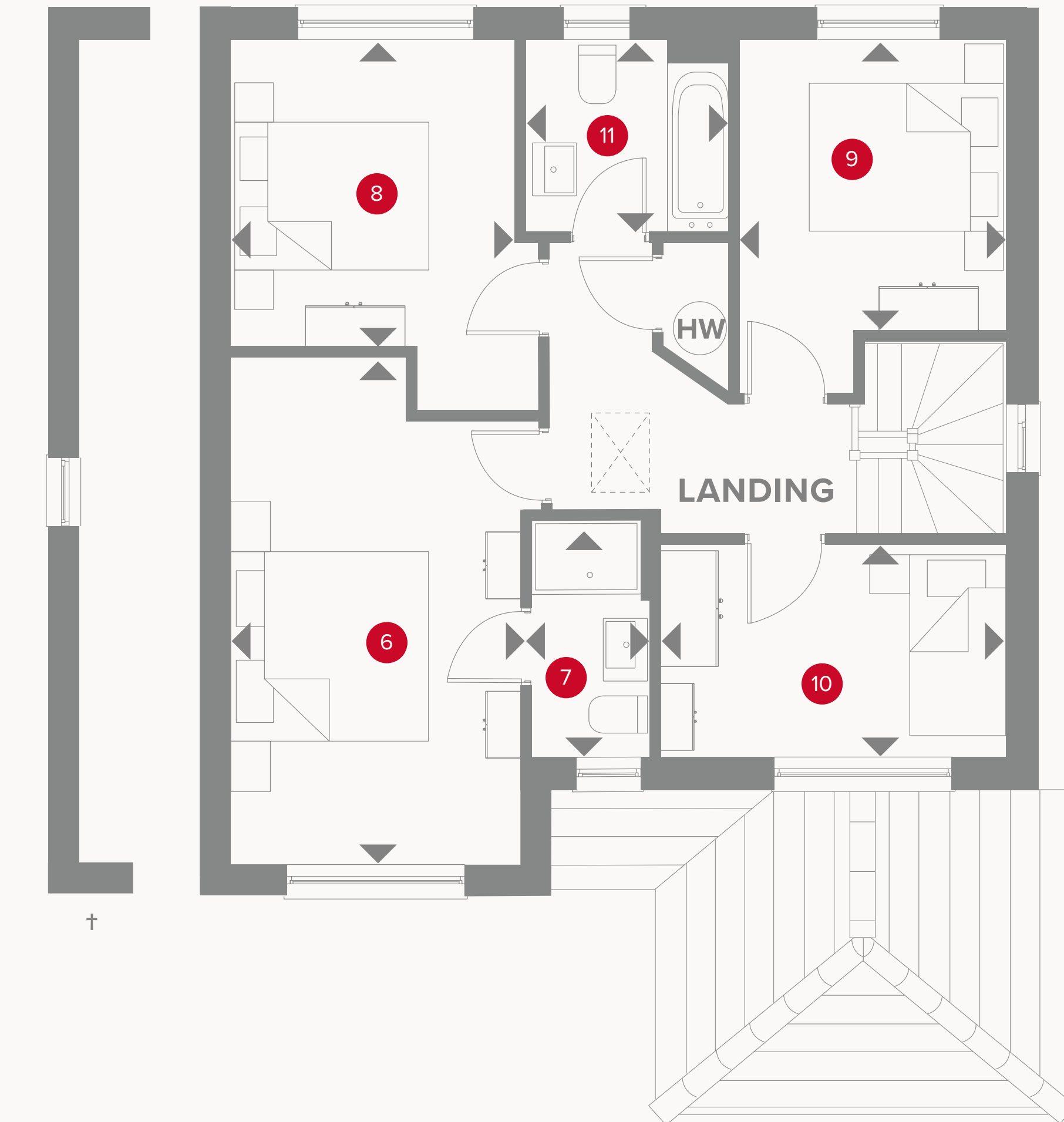

† Denotes alternative elevation

**CONSUMER
CODE FOR
HOME BUILDERS**
www.consumercode.co.uk

Customers should note this illustration is an example of the Windsor house type. All dimensions indicated are approximate and the furniture layout is for illustrative purposes only. Homes may be "handed" (mirror image) versions of the illustrations, and may be detached, semi-detached or terraced. Materials used may differ from plot to plot including render and roof tile colours. Detailed plans and specifications are available for inspection for each plot at our Sales Centre during working hours and customers must check their individual specifications prior to making a reservation. Computer generated images are for indicative purposes only.

KEY

◀ Dimensions start **LH** Loft hatch
HW Hot water cylinder