



**INSPIRED**

- REDROW -

# **THE CAVENDISH SEMI**

THREE BEDROOM HOME



# THE CAVENDISH SEMI GROUND FLOOR

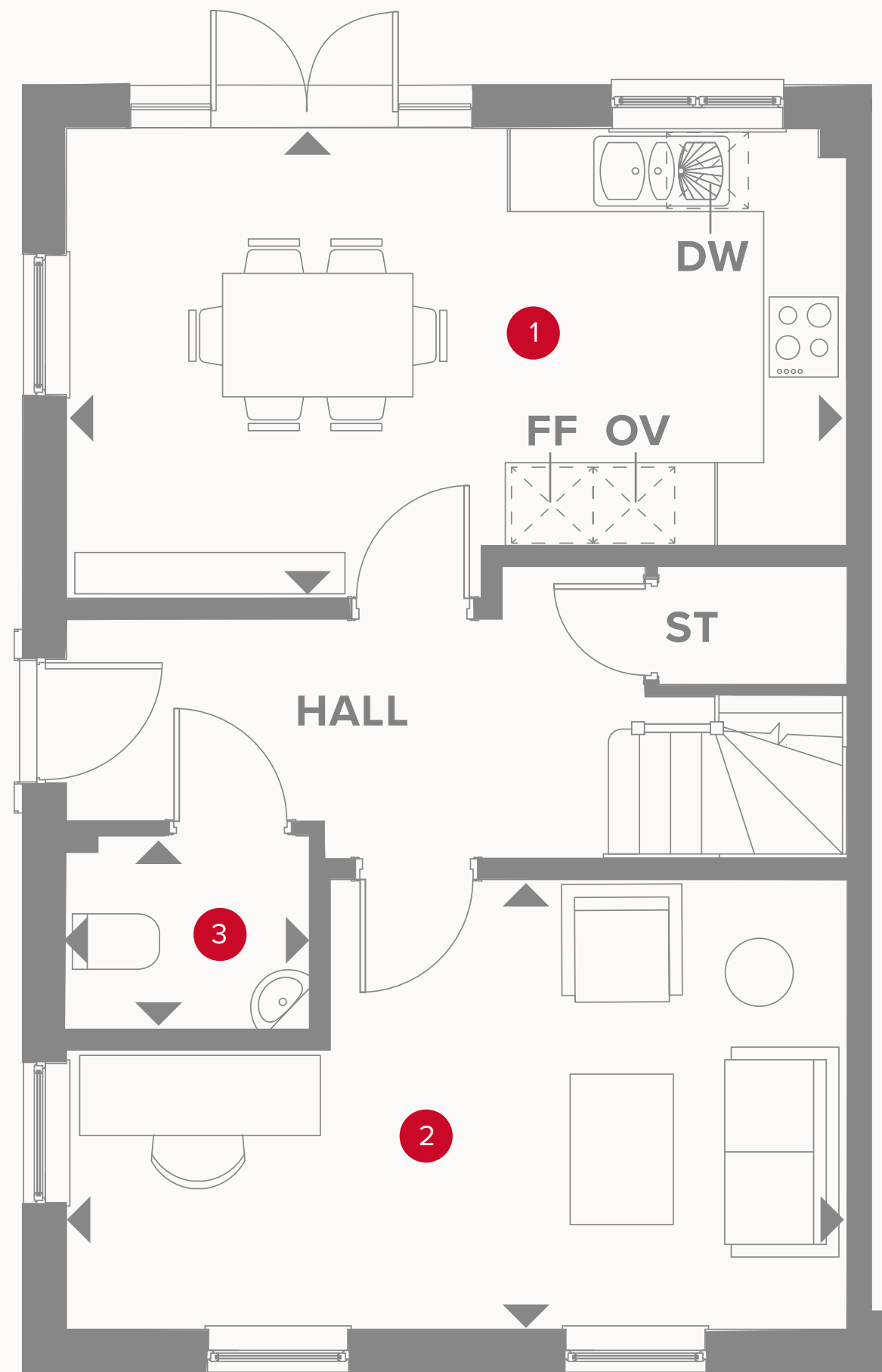



1	Kitchen/Dining	18'6" x 11'2"	5.65 x 3.40 m
2	Family/Study	18'7" x 10'11"	5.66 x 3.32 m
3	Cloaks 1	5'9" x 3'5"	1.76 x 1.05 m



## KEY

 Hob  
 Oven

 Dimensions start  
 Storage cupboard

# THE CAVENDISH SEMI FIRST FLOOR

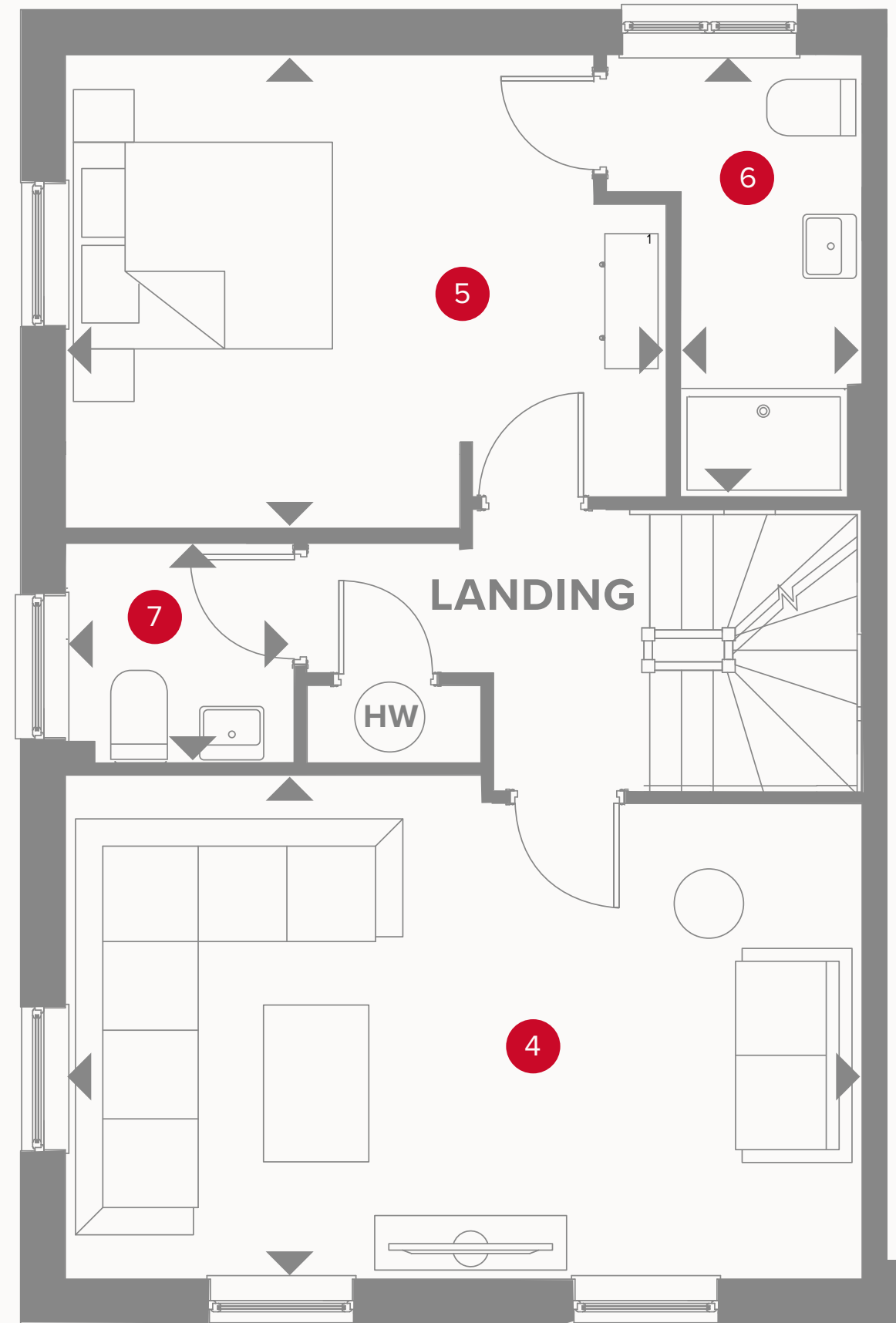

4	Lounge	18'6" x 11'9"	5.65 x 3.58 m
5	Bedroom 1	14'0" x 11'0"	4.27 x 3.36 m
6	En-suite	10'4" x 6'0"	3.14 x 1.82 m
7	Cloaks 2	5'4" x 5'2"	1.63 x 1.58 m



## KEY

- ◀ Dimensions start
- HW Hot Water

# THE CAVENDISH SEMI SECOND FLOOR

8	Bedroom 2	13'5" x 8'2"	4.08 x 2.50 m
9	Bedroom 3	13'5" x 9'1"	4.08 x 2.27 m
10	Bathroom	6'6" x 5'7"	1.99 x 1.71 m

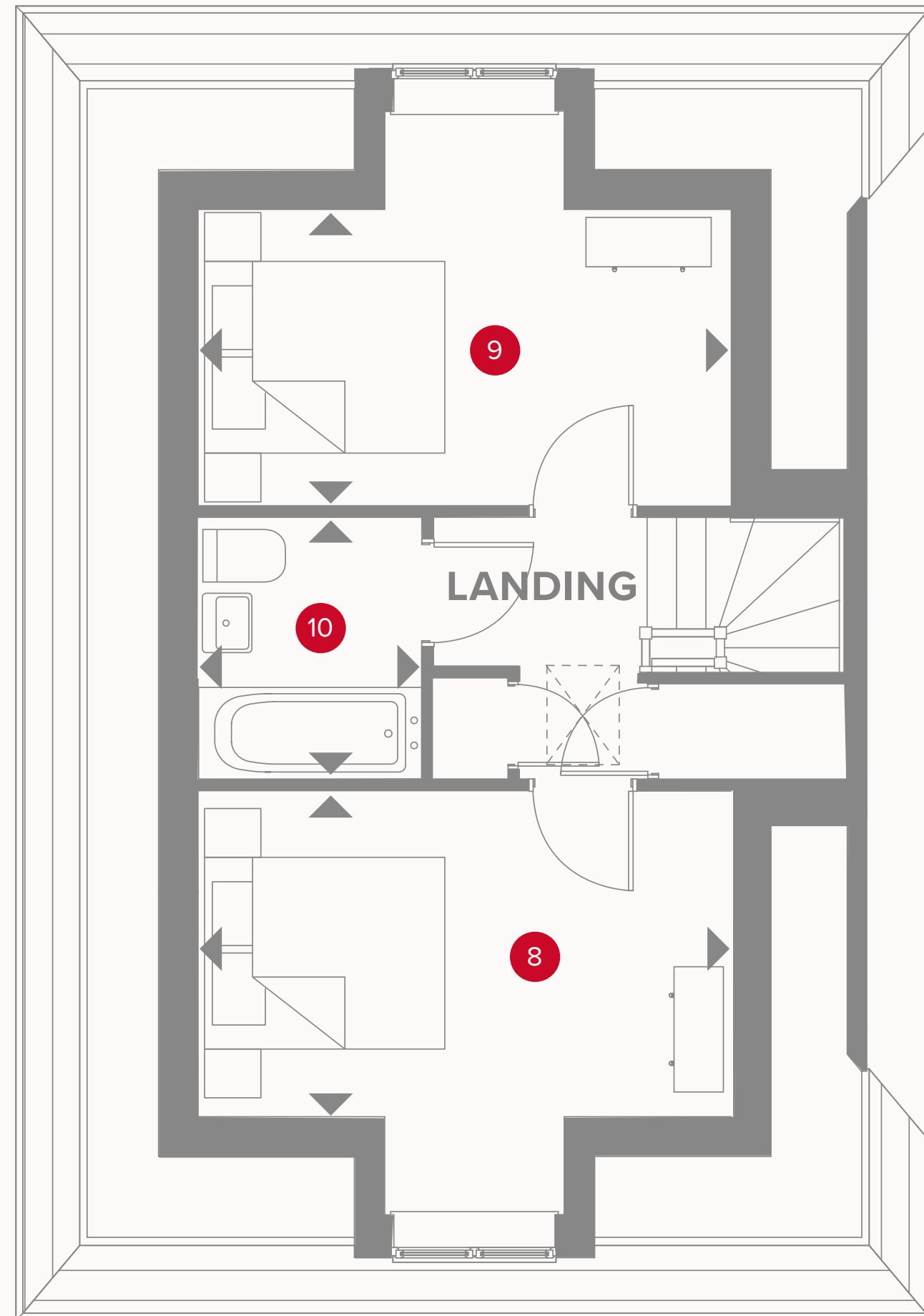

## KEY

◀ Dimensions start



Customers should note this illustration is an example of the Cavendish Semi house type. All dimensions indicated are approximate and the furniture layout is for illustrative purposes only. Homes may be 'handed' (mirror image) versions of the illustrations, and may be detached, semi-detached or terraced. Materials used may differ from plot to plot including render and roof tile colours. Detailed plans and specifications are available for inspection for each plot at our Customer Experience Suite during working hours and customers must check their individual specifications prior to making a reservation.