



HERITAGE

- REDROW -

THE BALMORAL

FOUR BEDROOM HOME



THE BALMORAL GROUND FLOOR

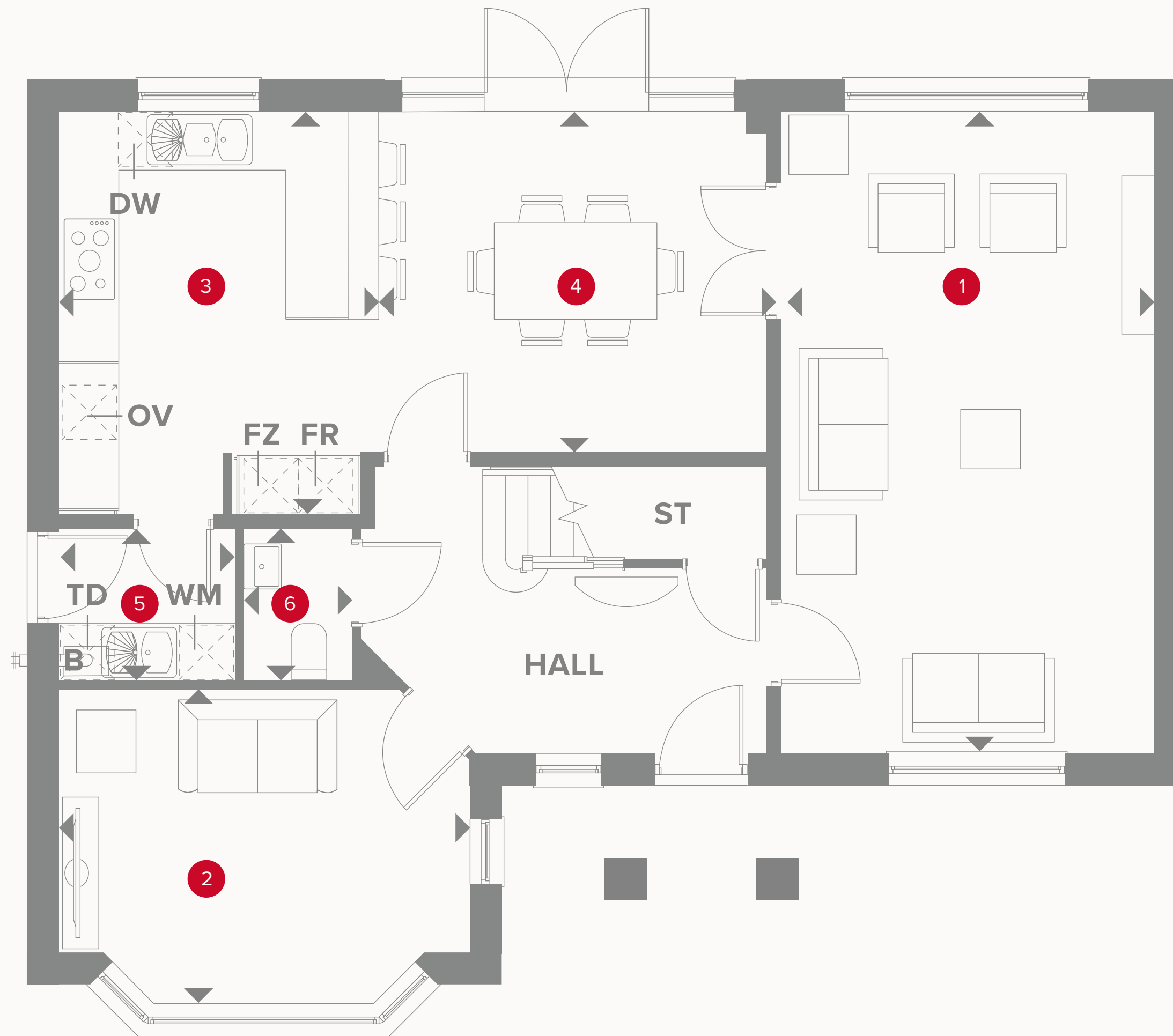

1	Lounge	21'3" x 12'5"	6.5 x 3.8 m
2	Family room	13'5" x 10'2"	4.1 x 3.1 m
3	Kitchen	10'5" x 13'5"	3.2 x 4.1 m
4	Dining	12'8" x 11'2"	3.9 x 3.4 m
5	Utility	5'10" x 4'11"	1.8 x 1.5 m
6	Cloaks	4'11" x 3'7"	1.5 x 1.1 m



KEY

Hob
OV Oven
FR Fridge
FZ Freezer

Dimensions start
TD Tumble dryer space
WM Washing machine space
DW Dishwasher space

ST Storage cupboard
B Boiler

THE BALMORAL FIRST FLOOR

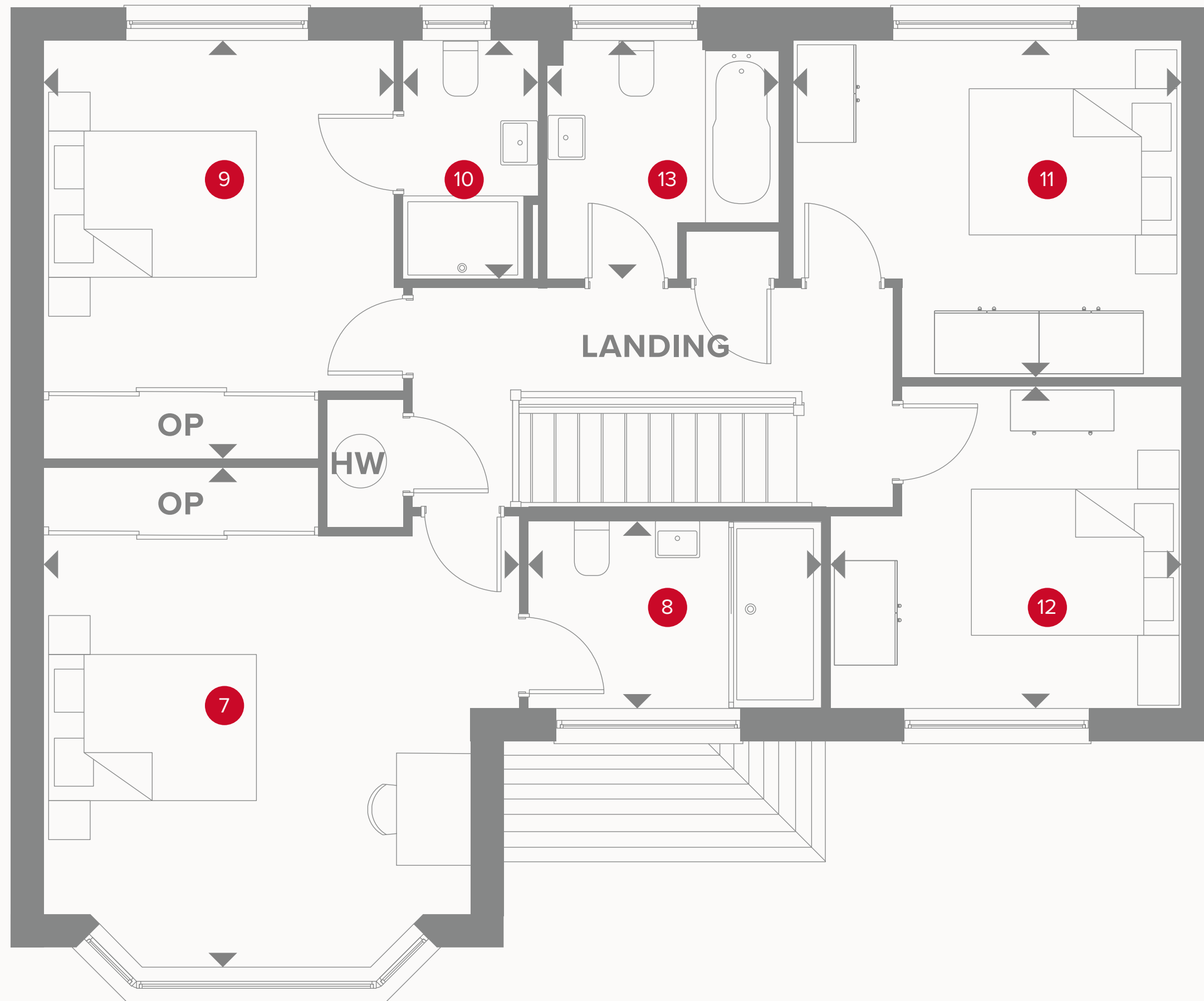

7	Bedroom 1	15'7" x 13'5"	4.8 x 4.1 m
8	En-suite 1	9'2" x 5'10"	2.8 x 1.8 m
9	Bedroom 2	13'5" x 11'5"	4.1 x 3.4 m
10	En-suite 2	7'5" x 4'3"	2.3 x 1.3 m
11	Bedroom 3	12'5" x 10'9"	3.8 x 3.3 m
12	Bedroom 4	11'1" x 10'2"	3.4 x 3.1 m
13	Bathroom	7'5" x 7'2"	2.3 x 2.2 m



KEY

- ◀ Dimensions start
- OP Customer option
- HW Hot water storage



Customers should note this illustration is an example of the Henley house type. All dimensions indicated are approximate and the furniture layout is for illustrative purposes only. Homes may be 'handed' (mirror image) versions of the illustrations, and may be detached, semi-detached or terraced. Materials used may differ from plot to plot including render and roof tile colours. Detailed plans and specifications are available for inspection for each plot at our Sales Centre during working hours and customers must check their individual specifications prior to making a reservation.