



THE HOLYWELL II

Three Bedroom Home



THE HOLYWELL II

Three Bedroom home | 1,154 sq ft

HOMES 54, 87, 88, 95, 96, 109 & 110

GROUND FLOOR

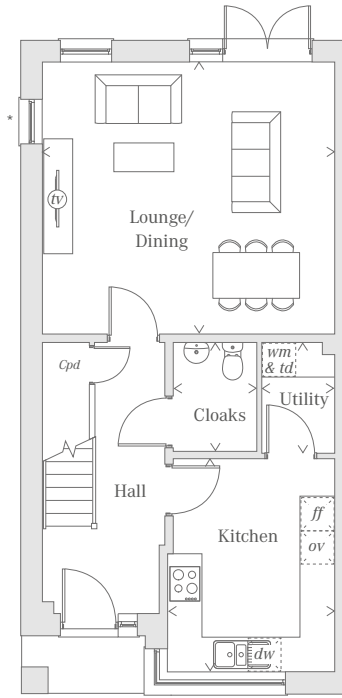

FIRST FLOOR

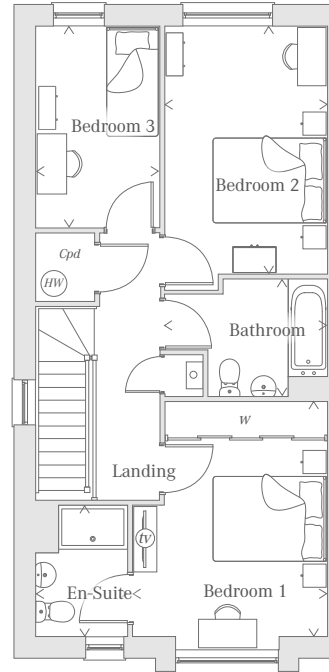

GROUND FLOOR

Lounge/ Dining	16'8" x 15'6"	5.07 x 4.73 m
Kitchen	12'2" x 9'7"	3.70 x 2.92 m
Cloaks	6'0" x 4'9"	1.83 x 1.45 m
Utility	6'4" x 4'1"	1.92 x 1.26 m

FIRST FLOOR

Bedroom 1	13'5" x 9'4"	4.08 x 2.85 m
En-suite	6'11" x 4'11"	2.12 x 1.49 m
Bedroom 2	13'3" x 9'3"	4.04 x 2.82 m
Bedroom 3	11'6" x 7'0"	3.50 x 2.14 m
Bathroom	9'3" x 6'8"	2.82 x 2.04 m

Plots 87-110 external elevations are as per the show home. Please ask Sales Consultants for more details.

*Plots 87, 88, 95, 96 window in lounge omitted.



Customers should note this illustration is an example of The Holywell II house type and shows homes 54, 87, 88, 95, 109 & 110. All maximum dimensions indicated are approximate and the furniture layout is for illustrative purposes only. Homes may be 'handed' (mirror image) versions of the illustrations, and may be detached, semi-detached or terraced. Materials used may differ from plot to plot including render and roof tile colours. Detailed plans and specifications are available for inspection for each plot at our Sales Centre during working hours and customers must check their individual specifications prior to making a reservation.

Redrow.co.uk give notice that the property particulars and related information on this site, whilst believed to be accurate, are set as a general outline for guidance only. Intending purchasers should not rely on them as statements or representations of fact, but must satisfy themselves before physical inspection as to their availability, or by physical inspection of the property in question or otherwise as to their accuracy or fit for purpose. Consequently, no information displayed on this site (or linked sites) constitutes or forms part of a contract. Materials used may differ from plot to plot including render and roof tile colours.

< Denotes where dimensions are taken from. Floorplan scale may vary across house types.

KEY

Hob	<i>td</i> Space for Tumble dryer
<i>ov</i> Oven	TV Point
<i>ff</i> Fridge/Freezer	<i>W</i> Wardrobe
<i>dw</i> Space and plumbing for Dishwasher	Hot water cylinder
<i>wm</i> Space and plumbing for Washing machine	<i>Cpd</i> Cupboard

