



HERITAGE

- REDROW -

THE HARROGATE

FOUR BEDROOM DETACHED HOME



THE HARROGATE GROUND FLOOR

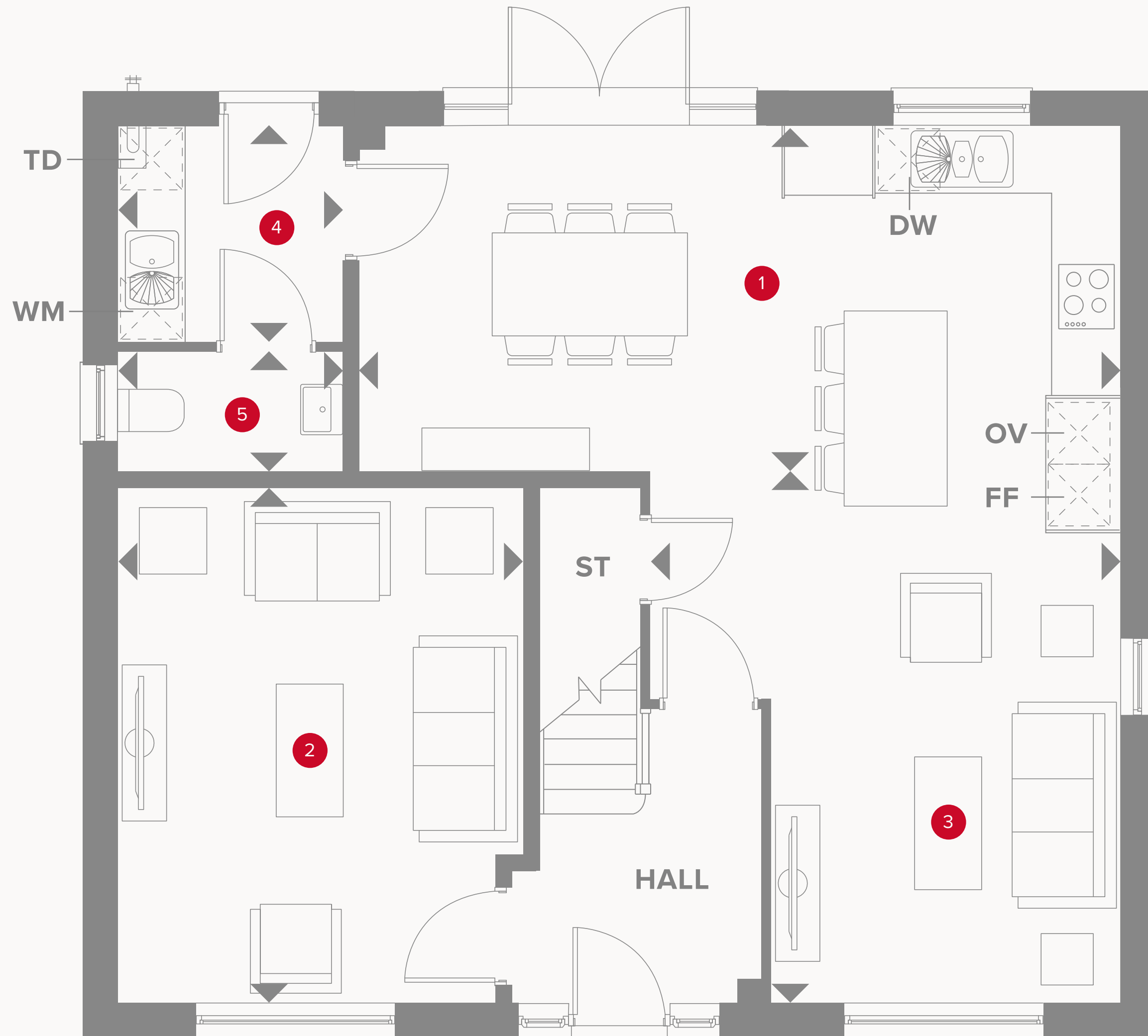

1	Kitchen/Dining	23'5" x 10'5"	7.09 x 3.16m
2	Lounge	15'5" x 12'1"	4.63 x 3.65m
3	Family	15'9" x 14'0"	4.75 x 4.23m
4	Utility	6'5" x 5'11"	1.95 x 1.80m
5	Cloaks	5'11" x 3'7"	1.80 x 1.09m



KEY

-  Hob
- OV** Oven
- FF** Fridge/freezer
- TD** Tumble dryer space

-  Dimensions start
- ST** Storage cupboard
- WM** Washing machine space
- DW** Dish washer space

THE HARROGATE FIRST FLOOR

6	Bedroom 1	12'4" x 10'5"	3.72 x 3.15m
7	En-suite	8'4" x 5'7"	2.53 x 1.69m
8	Wardrobe	6'7" x 6'6"	2.00 x 1.96m
9	Bedroom 2	13'8" x 10'4"	4.13 x 3.11m
10	Bedroom 3	12'2" x 10'4"	3.69 x 3.11m
11	Bedroom 4	11'3" x 9'7"	3.40 x 2.89m
12	Bathroom	7'8" x 6'2"	2.31 x 1.86m



**CONSUMER
CODE FOR
HOME BUILDERS**
www.consumercode.co.uk

Customers should note this illustration is an example of the Harrogate house type. All dimensions indicated are approximate and the furniture layout is for illustrative purposes only. Homes may be "handed" (mirror image) versions of the illustrations, and may be detached, semi-detached or terraced. Materials used may differ from plot to plot including render and roof tile colours. Detailed plans and specifications are available for inspection for each plot at our Sales Centre during working hours and customers must check their individual specifications prior to making a reservation. Computer generated images are for indicative purposes only.

KEY

- ◀ Dimensions start
- HW** Hot water storage

