

RAWDON
3 BEDROOM HOME
DETACHED



LEEDS



RAWDON

3 BEDROOM HOME

DETACHED

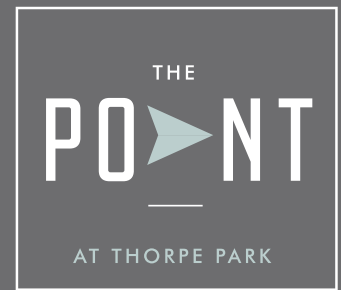

LEEDS

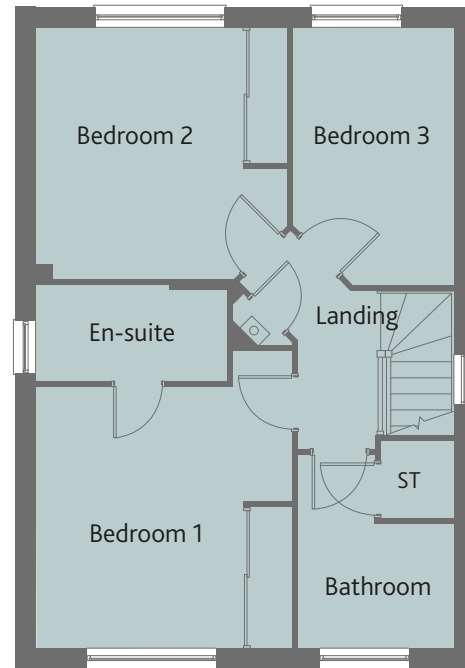
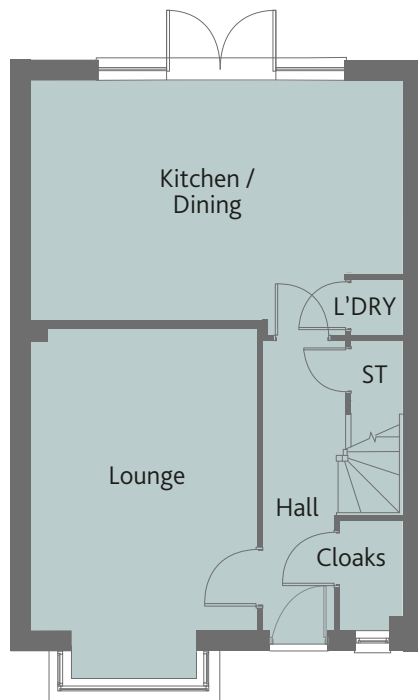

A sense of quality and craftsmanship is evident throughout this home.

With a well designed kitchen/diner, a comfortable lounge and three spacious bedrooms, the Rawdon will continue to please.

GROUND FLOOR

Kitchen/ Dining	19'0" x 12'2"	5.81 x 3.72 m
Lounge	15'5" x 11'6"	4.75 x 3.55 m
Cloaks	5'7" x 3'0"	1.74 x 1.01 m
Laundry	3'1" x 3'1"	0.96 x 0.96 m

FIRST FLOOR

Bedroom 1	12'0" x 11'7"	3.67 x 3.59 m
En-suite 1	8'7" x 4'2"	2.67 x 1.30 m
Bedroom 2	11'5" x 11'5"	3.53 x 3.52 m
Bedroom 3	11'8" x 7'2"	3.62 x 2.22 m
Bathroom	8'8" x 7'0"	2.68 x 2.16 m

KEY  Hob ST Cupboard

Note: Bedroom dimensions taken into wardrobe recess.

All wardrobes are subject to site specification. Please see Sales Consultant for further details.

**CONSUMER
CODE FOR
HOME BUILDERS**

www.consumercode.co.uk

Customers should note this illustration is an example of the Rawdon house type. All dimensions indicated are approximate and the furniture layout is for illustrative purposes only. Homes may be 'handed' (mirror image) versions of the illustrations, and may be detached, semi-detached or terraced. Materials used may differ from plot to plot including render and roof tile colours. Detailed plans and specifications are available for inspection for each plot at our Sales Centre during working hours and customers must check their individual specifications prior to making a reservation.

 **REDROW**
A BETTER WAY TO LIVE